



ihouse
SINCE 1998

C
R
E
A
T
E
F
O
R
U



WHAT'S NEW?



江門外貿集團有限公司
JIANGMEN FOREIGN TRADE GROUP CO., LTD.
I HOUSE ENTERPRISE CO., LTD

ihouse[®]
SINCE 1998

BRIEF Introduction

Jiangmen Foreign Trade Group Co., Ltd. was established in 1998. It engages in the business of import-export, the design and manufacturing of industrial products. Large investment capital and professional foreign trade team have enabled Jiangmen, Guangdong and a leader in the field of foreign trading. Our company has powerful research and development capability. We have batch professors of Industrial Design major from well-known universities to be our technical consultants. Beyond that, a designing team consisting of experienced designers who are seniors of the international market and product trend. Moreover, we are offering different products with a worldwide of varieties and new designs to consumers all the time. Many of our products have owned related design patents in many districts and countries all over the world.

We mainly export household products, such as bathroom accessories, kitchenware, storage products and furnitures.

We have several intensive production bases, and have established close relationship with them. Our factories have top-ranking workshops and professional production lines. With scientific management, we always offer products in high quality to customers with the most favorable price. Moreover, our factories have audit certifications issued by notarization institutes such as BSCI and SEDOX.

Jiangmen Foreign Trade Group Co., Ltd. has already been the supplier of many famous supermarkets and department stores in the world, such as Wal-mart, Macy's, Heli and Carrefour. With years of efforts, we have many business partners around the world and have received many praises from our customers. "Equality, mutual benefit and sincere cooperation" is our business philosophy. We sincerely welcome domestic and foreign customer to visit and negotiate trading cooperation with us!

企业简介

江门外贸集团有限公司成立于1998年，经营进出口贸易和工业产品的设计和生产品等业务。我们拥有较强的外贸专业队伍，资金实力雄厚，多年来进出口额在广东、江门外贸行业名列前茅，是江门外贸行业龙头企业。

公司拥有强大的新产品研发能力，包括拥有由国内知名大学工业设计专业的教授担任的技术顾问，以及一批熟悉国际市场，了解产品潮流的资深设计师组成的设计团队，不断为客户提供各种新颖、优秀的设计，公司同时拥有大量不同国家和地区的设计专利。

我们还拥有多个紧密型货源生产基地，与工厂建立了紧密的合作伙伴关系。我们的工厂都拥有一定的厂房和专业的生产流水线，加上科学的管理，能为客户提供各种价廉物美的产品，并有BSCI、SEDEX等公认证书的验厂证。

经过多年努力，江门外贸集团有限公司现已成为全球各大超市如沃尔玛、梅西百货、家乐福等的供应商。公司贸易伙伴遍布全球，赢得了广大用户的赞誉。

“平等互利，真诚合作”是我们的经营理念。诚挚欢迎国内外客商来洽谈贸易和合作事宜。







1

- | | | | |
|---|-----------|----------------------|-------|
| 1 | 960076ASE | Ø20.5X31.5Hcm | (5L) |
| | 960076BSE | Ø26.5X42.5Hcm | (13L) |
| | 960076CSE | Ø29.5X63Hcm | (25L) |
| 2 | 960485 | Ø9X24.5HicmX37.5H:cm | |



2



NEW

PAHs



Soft Close



Fingerprint Resistant

2



1



- | | | | |
|---|---------|-------------|-------|
| 1 | 960890 | 41X36X47Hcm | (30L) |
| 2 | 960890E | 41X36X47Hcm | (30L) |





3

PAHs



Soft Close



Fingerprint Resistant



| | | | |
|---|---------|-----------------|-------|
| 3 | 961013 | 58.5X36X54.5Hcm | (48L) |
| | 961049 | 58.5X36X65Hcm | (60L) |
| 4 | 961013E | 58.5X36X54.5Hcm | (48L) |
| 5 | 961049E | 58.5X36X65Hcm | (60L) |

NEW



4



5

CE RoHS



Soft Case

Fingerprint Resistant

Sensor

SENSOR BIN



1



2

- 1 960655 30x28.5x67Hcm (30L)
- 960656 30x28.5x56.5Hcm (24L)
- 2 960653 58x30x67Hcm (60L)
- 960654 58x30x56.5Hcm (48L)

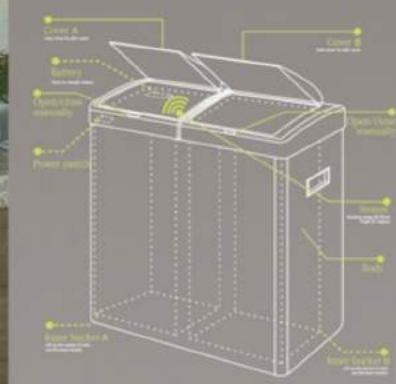

Battery:AA 4PCS

Battery:AA 8PCS



ihouse®

SINCE 1998



Battery:SIZE D 4PCS



- 3 960430 Ø31x69.5Hcm (30L)
- 4 960660 Ø29.3x68Hcm (30L)
- 5 960601 36x30.4x62.5Hcm (24L)



Battery:AA 4PCS





- 1 960412 53.5X23.5X63Hcm (40L)
- 2 960420 33X40X51.5Hcm (15LX2)

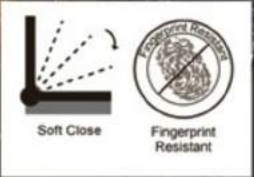



3 960407A 48X38X68.2Hcm (50L)
960407B 27.5X22X37.5Hcm (6L)



4 960408A 37X47.5X68.5Hcm (50L)
960408B 31X23.5X36Hcm (8L)



5 960410A 45.5X28.5X67Hcm (40L)
960410B 31X18.5X41Hcm (10L)



6 960157A 31X19.5X41Hcm (10L)
960157B 46X29.5X66.5Hcm (40L)

NEW



16LX2

1



- | | | |
|---|--------|---------------------------|
| 1 | 960260 | 43 X 33 X 63Hcm (16L X 2) |
| 2 | 959586 | 46.5 X Ø39 X 66Hcm (40L) |

2



PUSH FOR MORE SPACE



NEW



16LX2

1



- | | | |
|---|--------|---------------------------|
| 1 | 960260 | 43 X 33 X 63Hcm (16L X 2) |
| 2 | 959586 | 46.5 X Ø39 X 66Hcm (40L) |

2



PUSH FOR MORE SPACE





1



2



3

NEW

1 960441 26X25.5X49.5Hcm(15L) (SLOW DOWN SYSTEM)

2 958070A 32X24X41Hcm(12L)

958070B 39X31.5X49.5Hcm(27L)

958070C 36.5X28.7X58Hcm(30L)

3 960777A 37X26.5X65Hcm(30L)

960777B 32X26.5X44Hcm(20L)

4 960188 26.5X22.5X37.5Hcm (8L)

5 959452 47X33X63Hcm (50L) (SLOW DOWN SYSTEM)

6 959130 40X37X55Hcm(18LX2) (SLOW DOWN SYSTEM)



5

4



6

| | | | | | | | |
|---|----------|---------------|-------|---|---------|-------------------|-------|
| 7 | 960895EA | 30X24X43.5Hcm | (12L) | 8 | 961050A | 21.5X18.5X30Hcm | (5L) |
| | 960895EB | 34X28X45.5Hcm | (20L) | | 961050B | 35X30X63.5Hcm | (30L) |
| | 960895EC | 34X28X68Hcm | (30L) | | 961050C | 42.5X37.2X65.7Hcm | (50L) |

ihouse[®]
SINCE 1998



7



8



11



10

| | | | |
|----|----------|-------------------|-------|
| 9 | 961050AE | 21.5X18.5X30Hcm | (5L) |
| | 961050BE | 35X30X63.5Hcm | (30L) |
| | 961050CE | 42.5X37.2X65.7Hcm | (50L) |
| 10 | 960588A | 23xØ17.8x24.5Hcm | (3L) |
| | 960588B | 27xØ21.5x30Hcm | (5L) |
| | 960588C | 33.5xØ26.5x43Hcm | (12L) |
| | 960588D | 39xØ31x47Hcm | (20L) |
| | 960588E | 39xØ31x64.5Hcm | (27L) |
| | 960588F | 39xØ31x68Hcm | (30L) |

| | | | |
|----|----------|------------------|-------|
| 11 | 960588EA | 23xØ17.8x24.5Hcm | (3L) |
| | 960588EB | 27xØ21.5x30Hcm | (5L) |
| | 960588EC | 33.5xØ26.5x43Hcm | (12L) |
| | 960588ED | 39xØ31x47Hcm | (20L) |
| | 960588EE | 39xØ31x64.5Hcm | (27L) |
| | 960588EF | 39xØ31x68Hcm | (30L) |

| | | | |
|----|----------|-------------------|-------|
| 12 | 960587EA | 23x22.5x32.5Hcm | (6L) |
| | 960587EB | 27.2x25.5x40.2Hcm | (12L) |
| | 960587EC | 34.5x32.5x61.5Hcm | (30L) |
| 13 | 960587A | 23x22.5x32.5Hcm | (6L) |
| | 960587B | 27.2x25.5x40.2Hcm | (12L) |
| | 960587C | 34.5x32.5x61.5Hcm | (30L) |
| 14 | 960896AE | 31.5X19X39Hcm | (10L) |
| | 960896BE | 46.5X29.5X64.5Hcm | (40L) |
| 15 | 960896A | 31.5X19X39Hcm | (10L) |
| | 960896B | 46.5X29.5X64.5Hcm | (40L) |

NEW BINS



14



15



13



12



| | | | |
|---|---------|------------------|-------|
| 1 | 960595 | 37xØ29.5x59Hcm | (30L) |
| 2 | 960594A | 23.5xØ16.5x22Hcm | (3L) |
| | 960594B | 25.5xØ20x28Hcm | (5L) |
| | 960594C | 30.5xØ23x41Hcm | (12L) |
| | 960594D | 39xØ30x62Hcm | (30L) |
| 3 | 960440A | 26.5X21X27Hcm | (5L) |
| | 960440B | 32X25.7X38.5Hcm | (12L) |
| | 960440C | 38X30X43.8Hcm | (20L) |
| | 960440D | 38X30X61Hcm | (27L) |
| | 960440E | 38X30X64Hcm | (30L) |

| | | | |
|---|---------|---------------|--------------------------|
| 4 | 960077A | Ø20.5X27Hcm | (5L) |
| | 960077C | Ø29.5X43Hcm | (20L) |
| | 960077D | Ø29.5X63.5Hcm | (30L) |
| 5 | 960187D | 37X31X46.5Hcm | (20L) (SLOW DOWN SYSTEM) |
| | 960187E | 37X31X66.8Hcm | (30L) (SLOW DOWN SYSTEM) |
| 6 | 959022A | Ø17X26Hcm | (3L) |
| | 959022B | Ø20.5X31Hcm | (5L) |
| | 959022C | Ø25.2X42Hcm | (12L) |
| | 959022D | Ø29.5X48Hcm | (20L) |
| | 959022E | Ø29.5X67.5Hcm | (30L) |





7



8



9



| | | | |
|-----------|---------|-----------------------|--------------------|
| 7 | 959067 | 37X26X67.5Hcm | (30L) |
| 8 | 959066 | 31X22X42Hcm | (12L) |
| 9 | 959065 | 25.5X18X29.5Hcm | (5L) |
| 10 | 959989A | 25.5X17X30Hcm | (5L) |
| | 959989D | 37X25.5X66.5Hcm | (30L) |
| 11 | 960438 | 41X38.5X63Hcm (16LX2) | (SLOW DOWN SYSTEM) |
| 12 | 960078 | 38X29.5X46Hcm (13LX2) | (SLOW DOWN SYSTEM) |



10



VERY NEW



11



12



- 2 960437EA 41X38.5X60Hcm(40L)
- 3 960437EC 34X33X43.5Hcm(20L)
- 4 960437EB 28.5X28X39.5Hcm(12L)

SLOW DOWN SYSTEM

- 1 960437A 41X38.5X60Hcm (40L)
- 960437B 28.5X28X39.5Hcm (12L)
- 960437C 34X33X43.5Hcm (20L)



5 960803E 14X27X29.5Hcm (5L)
6 960803 14X27X29.5Hcm (5L)
7 960696S Ø25x47.5Hcm
960696L Ø25x56Hcm

8 960696SE Ø25x47.5Hcm
960696LE Ø25x56Hcm
9 960776A Ø20x31Hcm (5L)
960776B Ø24.5x42Hcm (12L)
960776C Ø29x48Hcm (20L)





- 1 947448ASE Ø20X29Hcm (3L)
 947448BSE Ø24.5X32Hcm (5L)
 947448CSE Ø29X43.5Hcm (12L)
 947448DSE Ø33X49Hcm (20L)
 947448ESE Ø33X67.5Hcm (30L)



- 2 957402A Ø17X25.5Hcm (3L)
 957402B Ø20.5X28.5Hcm (5L)
 957402C Ø25.5X41Hcm (12L)
 957402D Ø29.5X46Hcm (20L)
 957402E Ø29.5X66.5Hcm (30L)



- 3 927802ASE 16X16X24.5Hcm (3L)
 927802BSE 19X19X27.5Hcm (5L)
 927802CSE 20X20X29Hcm (6L)
 927802DSE 23X23X37.5Hcm (12L)
 927802ESE 26.8X26.8X41.5Hcm (20L)
 927802GSE 29X29X63.5Hcm (27L)
 927802FSE 29X29X65.5Hcm (30L)



- 4 903979EE Ø34X65Hcm (40L)
 905567E Ø29X66Hcm (30L)
 903979DE Ø29X61Hcm (27L)
 905566E Ø29X45Hcm (20L)
 903979CE Ø25X39Hcm (12L)
 927795E Ø20.5X30.7Hcm (7L)
 903979BE Ø20.5X27Hcm (5L)
 903979AE Ø17X24.5Hcm (3L)

- 5 927984A Ø17X27Hcm (3L)
 927984B Ø20.5X30Hcm (5L)
 927984C Ø25X43Hcm (12L)
 927984D Ø29.5X46Hcm (20L)
 927984E Ø29.5X68Hcm (30L)
 927984F Ø36x66.5Hcm (40L)



- 6 927250A Ø17X27Hcm (3L)
 927250B Ø20.5X30Hcm (5L)
 927250C Ø25X43Hcm (12L)
 927250D Ø29.5X46Hcm (20L)
 927250E Ø29.5X68Hcm (30L)
 927250F Ø36x66.5Hcm (40L)





BATHROOM



A B C D

| | | | |
|----|------------|---------------|-------|
| 11 | 959601 ISA | Ø16.8x25.7Hcm | (3L) |
| | 959601 ISB | Ø20x27Hcm | (5L) |
| | 959601 ISC | Ø25x39Hcm | (12L) |
| | 959601 ISD | Ø19x44.5Hcm | (20L) |
| | 959601 ISE | Ø29x65Hcm | (30L) |

| | | | |
|----|---------|-----------------------|------|
| 1 | 960235 | 2PCS/SET | (5L) |
| 2 | 960194A | Ø20x26.5x26.5Hcm | (5L) |
| 3 | 960193A | Ø9.5x21H.x28.5H.cm | |
| 4 | 960195A | Ø14.5x39.5Hcm | |
| 5 | 960687 | Ø14.5x38.5Hcm | |
| 6 | 960688 | Ø10x27H.x38H.cm | |
| 7 | 960686 | Ø16.5x22x25.5Hcm | |
| 8 | 960134A | Ø24.5x27Hcm | |
| 9 | 9596031 | Ø9.7x27.5H.cm x39H.cm | |
| 10 | 9596021 | Ø14x37Hcm | |



WITH BAGS SAVER

ihouse[®]
SINCE 1998



- 12** 947605R 41x34x48.5Hcm (30L)
- 13** 947421R 31x26.5x39.5Hcm (16L)
- 14** 957403R 58.5x32.5x53.3Hcm (48L)
- 15** 956610 15.5x24.5x33Hcm (8L)



- 16** 960589A 23x21x28Hcm (5L)
- 960589B 30x29x38Hcm (12L)
- 960589C 35.5x34x62Hcm (30L)
- 17** 960589EA 23x21x28Hcm (5L)
- 960589EB 30x29x38Hcm (12L)
- 960589EC 35.5x34x62Hcm (30L)



PUSH



- | | | |
|---|----------|----------------|
| 1 | 960011ES | Ø25X60Hcm(25L) |
| | 960011EM | Ø29X66Hcm(35L) |
| | 960011EL | Ø35X76Hcm(50L) |
| 2 | 960012E | Ø29X66Hcm(35L) |
| 3 | 960013 | Ø25X68Hcm(25L) |
| 4 | 960011S | Ø25X60Hcm(25L) |
| | 960011M | Ø29X66Hcm(35L) |
| | 960011L | Ø35X76Hcm(50L) |



Hinge function with a silicon shock absorber stabilizes the opening process



7



5

- | | | |
|----|---------|------------------------------|
| 5 | 960600 | 35.5x34.5x71.5Hcm(55L) |
| | 960600E | 35.5x34.5x71.5Hcm(55L) |
| 6 | 959889 | 42.5X33X64Hcm(16Lx2) |
| 7 | 959451 | 47X30.5X60Hcm(50L) |
| 8 | 959852 | 25X19.5X35.5Hcm(13L) |
| 9 | 959854 | 30X25X45.5Hcm(26L) |
| 10 | 959853 | 31X17X35Hcm(17L) |
| 11 | 959849 | 3PCS/SET(15L)Ø24XØ30X37.5Hcm |
| 12 | 959855B | Ø26.5XØ21X33.5Hcm(12L) |
| 13 | 960148 | Ø13.5X21.5Hcm |
| 14 | 956180 | Ø30X32.5X69Hcm |
| 15 | 956171 | 2PCS/SET(15X4X7Hcm) |
| 16 | 960370 | Ø13X17.5Hcm(2L) |

6





colour options



ihouse[®]
SINCE 1998



8



9



10

Counter-Top Compost Pail with Charcoal Filter

Compost is a mixture of decayed plants and vegetable waste which is added to the soil to help plants grow.

Use for vegetable scraps, egg shells, coffee grounds and more

Specially designed lid with built-in charcoal filter provides for odor-free use for months
Extra charcoal filter included

Compost Bin Charcoal Filter Replacements

To replace filters, remove lid and discard old filter. Insert two activated charcoal filters into the lid.

Each filter is made of activated charcoal, a natural material that neutralizes odor.
For best results, replace the filters when odors become apparent.



13



14



16



12



15





- | | | |
|---|---------|-------------------|
| 1 | 956520W | 22X15.5X33.5Hcm |
| 2 | 956508W | 34X23X34Hcm |
| 3 | 956505W | 22.5X17X29Hcm |
| 4 | 956506W | Ø24.5X19X32Hcm |
| 5 | 956507W | Ø23XØ16.5X29.5Hcm |
| 6 | 956519W | Ø22X28Hcm |
| 7 | 956609W | 15.5X22X39Hcm |
| 8 | 956608W | 15.5X22X35.5Hcm |
| 9 | 956607W | 16X22X33Hcm |





10



11

12

- 18 956233C 25X18X30Hcm (5L)
- 19 956234C 17.3X12.5X16.5HX41H.cm
- 20 956235C Ø11.5X25.5HX37.5H.cm
- 21 956390 6PCS/SET
- 22 956391 Ø10X21HX36H.cm
- 23 956486 4PCS/SET
- 24 956497 8X8X15.5HX35H.cm
- 25 956488 8X8X15.5HX35H.cm
- 26 956487 4PCS/SET

MY NEW BATHROOM

- 10 956499 Ø10X21H.cmX40.5H.cm
- 11 956388 Ø11.8X25.3HX36H.cm
- 12 956387 4PCS/SET
- 13 956533 4PCS/SET
- 14 956230 Ø12X25.5HX36H.cm
- 15 956231 4PCS/SET
- 16 956236C 15.8X13.8HX23H.cm
- 17 956232C Ø19.5X29Hcm (5L)



13



14

15



16



17



18



19

20

colour options



21

22



23

24



25

26





BATHROOM



- | | | | | | |
|---|---------|-----------------------|----|--------|-----------------------|
| 1 | 956012 | 21X15X32Hcm (5L) | 6 | 956229 | 22X18X23Hcm (3L) |
| 2 | 956013 | Ø19X31.5Hcm (5L) | 7 | 956134 | 5PCS/SET |
| 3 | 955837R | Ø24X28.5X25.5Hcm (6L) | 8 | 956092 | 4PCS/SET |
| 4 | 956013R | Ø19X31.5Hcm (5L) | 9 | 956095 | 2PCS/SET |
| 5 | 956012R | 21X15X32Hcm (5L) | 10 | 956235 | Ø11.5X25.5H.X37.5H.cm |

colour options



- | | | |
|----|--------|------------------------|
| 11 | 956232 | Ø19.5X29Hcm(5L) |
| 12 | 956236 | 15.8X13.8X23Hcm (5L) |
| 13 | 956233 | 25X18X30Hcm (5L) |
| 14 | 956234 | 17.3X12.5X16.5HX41H.cm |





16



17



18

colour options



15

- | | | |
|----|---------|---------------------|
| 15 | 956160 | 4PCS/SET |
| 16 | 956156 | 4PCS/SET |
| 17 | 956161 | 4PCS/SET |
| 18 | 956158 | 4PCS/SET |
| 19 | 956191 | Ø19X31.5Hcm (5L) |
| 20 | 956159 | Ø10.3X37Hcm |
| 21 | 956318A | 2PCS/SET |
| 22 | 956260 | Ø8.9X38.5Hcm |
| 23 | 956029 | 15.5X12X54H.X21H.cm |
| 24 | 956317 | 25XØ21.5X22Hcm |
| 25 | 956179 | 25XØ21.5X22Hcm |
| 26 | 956152 | 26XØ22X22Hcm |



19

20



21



23

24



22



25

26



MY NEW BATHROOM





5

TOILET BRUSH



4



10

- | | | |
|----|--------|----------------------|
| 1 | 959936 | 11X11X40Hcm |
| 2 | 959938 | 11X11X43.5Hcm |
| 3 | 959792 | Ø12X12HX37H.cm |
| 4 | 959851 | Ø10.5X12.5HX37.5H.cm |
| 5 | 956132 | 12X12X13.5HX43.5H.cm |
| 6 | 959850 | 11X11X43.8cm |
| 7 | 956131 | 12X12X13.5HX40.5H.cm |
| 8 | 956145 | Ø10.5X12.5HX37.5H.cm |
| 9 | 956321 | Ø11.5X13HX40.5H.CM |
| 10 | 956322 | Ø11.5X13HX40.5H.CM |
| 11 | 956147 | Ø10.5X12.5HX37.5H.cm |
| 12 | 956146 | Ø10.5X12.5HX37.5H.cm |
| 13 | 956148 | Ø10.5X12.5HX37.5H.cm |
| 14 | 956564 | Ø10.5X12.5HX37.5H.cm |



14



9



7



11

12

13

3

8



More products

www.gdjftg.com



6





7



13



14

- 1 959836 Ø9X10Hcm
- 2 959835 Ø9X18.5Hcm
- 3 959837 Ø9X13Hcm
- 4 959797 Ø12.5X18.5HX39H.cm
- 5 959791 12.5X9.8X4Hcm
- 6 959939 4PCS/SET
- 7 956381 4PCS/SET
- 8 956386 Ø10X13.9HX38H.cm

- 9 956382 Ø7X12.8Hcm
- 10 956384 Ø7X18.4Hcm
- 11 956383 Ø7X11.9Hcm
- 12 956385 11.2X7.2X3.2Hcm
- 13 956166 4PCS/SET
- 14 956165 4PCS/SET
- 15 956155 4PCS/SET
- 16 956157 4PCS/SET



8



9



10



11



12



15



16



MY NEW BATHROOM

- 1 956421A 4PCS/SET
- 2 956422A Ø10X12.5H.cmX38.5H.cm
- 3 956421B 4PCS/SET
- 4 956422B Ø10X12.5H.cmX38.5H.cm
- 5 956423A 4PCS/SET
- 6 956424A 9.5X9.5X12H.cmX37H.cm
- 7 956424B 9.5X9.5X12H.cmX37H.cm
- 8 956423B 4PCS/SET
- 9 956413 Ø9X12H.cm
- 10 956419A 4PCS/SET



- 11 956420A 10.5X10.5X23.5H.cmX35.5H.cm
- 12 956419B 4PCS/SET
- 13 956420B 10.5X10.5X23.5H.cmX35.5H.cm
- 14 956417A Ø9X23H.cmX38H.cm



- 15 956416A 4PCS/SET
- 16 956416B 4PCS/SET
- 17 956417B Ø9X23H.cmX38H.cm





- 18 958046 Ø7X17Hcm
- 19 958047 Ø7X9Hcm
- 20 958045 Ø7X9Hcm
- 21 959937 12.5X8.5X2.5Hcm
- 22 959845 Ø7X11Hcm
- 23 959846 Ø7X11.5Hcm
- 24 959847 Ø7X18Hcm
- 25 956022 Ø13X3Hcm
- 26 959874 4PCS/SET
- 27 959875 4PCS/SET

- 28 959876 4PCS/SET
- 29 959844 Ø5.5XØ8 X17.5Hcm
- 30 959843 Ø5.5XØ6X12Hcm
- 31 959848 Ø5.5XØ8X11.5Hcm
- 32 956425 Ø11X3Hcm
- 33 960580 4PCS/SET
- 34 956603 Ø7x8.5x17.5Hcm
- 35 956601 Ø9.5x26H.cmX38Hcm
- 36 956602 Ø7x11.5Hcm
- 37 956604 12.5x9.5x3Hcm
- 38 956606 3PCS/SET





MY NEW BATHROOM

- 1 960825 Ø8X21Hcm
- 2 960828 Ø8X12.6Hcm
- 3 960827 16X4.5X11.5Hcm
- 4 960826 14X9.5X3Hcm
- 5 960852 Ø6.5X14.5Hcm
- 6 960851 Ø6.5X10.5Hcm
- 7 960850 Ø6.5X9.5Hcm
- 8 960853 Ø9X25H.X38H.cm
- 9 960849 Ø11X2Hcm
- 10 960841 Ø6.5X9.5Hcm
- 11 960847 Ø9X26H.X39H.cm
- 12 960838 Ø5.5X21Hcm
- 13 960845 Ø6.5X10.5Hcm



- 14 960843 Ø11X2Hcm
- 15 960846 Ø9X26H.X39H.cm
- 16 960839 Ø5.5X21Hcm
- 17 960844 Ø6.5X10.5Hcm
- 18 960840 Ø6.5X9.5Hcm
- 19 960842 Ø11X2Hcm
- 20 960833 10X9X3Hcm
- 21 960829 Ø10X25H.X38H.cm
- 22 960834 Ø20X24Hcm
- 23 960830 Ø7X21Hcm
- 24 960832 Ø7X11Hcm
- 25 960831 Ø8X9.5Hcm
- 26 960973A Ø16.5x22.5x26Hcm (3L)
- 960973B Ø20x26x27.5Hcm (5L)
- 960973C Ø25x31.5x39.5Hcm (12L)
- 27 960978A Ø16.5x22.5x26Hcm (3L)
- 960978B Ø20x26x27.5Hcm (5L)
- 960978C Ø25x31.5x39.5Hcm (12L)





- 26 960978AE Ø16.5x22.5x26Hcm (3L)
960978BE Ø20x26x27.5Hcm (5L)
960978CE Ø25x31.5x39.5Hcm (12L)



- | | |
|-----------------------------------|----------------------|
| 29 960973AE Ø16.5x22.5x26Hcm (3L) | 32 960836 Ø19x25Hcm |
| 960973BE Ø20x26x27.5Hcm (5L) | 33 960981 Ø20x24Hcm |
| 960973CE Ø25x31.5x39.5Hcm (12L) | 34 960976 Ø20x24Hcm |
| 30 960835 Ø20x24.5Hcm | 35 960976E Ø20x24Hcm |
| 31 960837 Ø20x25.5Hcm | 36 960981E Ø20x24Hcm |





BATHROOM



- 1 959796 Ø11.5 X 8.5 X 13 Hcm X 41.5 Hcm
- 2 960526 Ø13 X 12 Hcm X 37.5 Hcm
- 3 959793 9 X 9 X 11 Hcm X 36 Hcm
- 4 960459 12 X 9.5 X 14 Hcm X 40 Hcm
- 5 960457 10.5 X 9.5 X 25 Hcm X 38 Hcm
- 6 960455 8 X 8 X 24.5 Hcm X 38 Hcm
- 7 960525 Ø10.5 X 10.5 Hcm X 36.5 Hcm
- 8 960524 Ø10.5 X 10.5 Hcm X 36.5 Hcm
- 9 960523 Ø12 X 11 Hcm X 36.5 Hcm
- 10 960669 Ø10X12Hcm
- 11 960670 8.2X8.2X12.4Hcm
- 12 960668 Ø14X10.5HX36H.cm
- 13 960453 Ø11.5X10.5Hcm

- 14 959839 Ø7.5X17.5Hcm
- 15 959840 Ø8.5X16.5Hcm
- 16 959841 Ø7.3X9X16Hcm
- 17 959842 Ø7.3X17Hcm
- 18 959809 Ø9X15.5Hcm
- 19 959810 Ø9X16Hcm
- 20 959811 Ø9X14.5Hcm
- 21 959792 Ø12 X 12 Hcm X 37 Hcm
- 22 959700 11.5 X 11.7 Hcm X 36.5 Hcm
- 23 959794 Ø12.3 X Ø9 X 12.5 Hcm X 38 Hcm
- 24 959795 Ø8.5 X Ø12 X 15.5 Hcm X 38.5 Hcm





- 25 960650 Ø9.5X27.5H.X38.5H.cm
- 26 960665 Ø11X27.5H.X42H.cm
- 27 960667 8.5X8.5X26H.X37H.cm
- 960667E 8.5X8.5X26H.X37H.cm
- 28 960979 Ø10X26.5H.X37.5H.cm
- 29 960980 Ø15X38H.cm
- 30 960975 Ø10X26.5H.X37.5H.cm
- 31 960974 Ø15X38H.cm
- 32 960979E Ø10X26.5H.X37.5H.cm
- 33 960980E Ø15X38H.cm
- 34 960975E Ø10X26.5H.X37.5H.cm
- 35 960974E Ø15X38H.cm
- 36 960821 Ø14X40H.cm
- 37 960824 Ø10.5X30H.X41.5H.cm
- 38 960823 Ø14X40H.cm



- 39 960820 Ø10.5X29H.X40.5H.cm
- 40 960819 Ø14X40.5H.cm
- 41 960581 Ø9.5X12H.X36H.cm
- 42 960666 Ø11X27.5H.X42H.cm
- 43 960649 Ø11X26H.X40.5H.cm
- 44 960822 Ø10.5X31H.X42H.cm





1 2 3 4



5 6 7



8 9 10



29 30 28 31



| | | | | | |
|----|--------|-----------------|----|--------|-------------------------|
| 1 | 959804 | 12.3X2.3Hcm | 17 | 959926 | 6.8X6.8X11Hcm |
| 2 | 959818 | Ø6.5X11Hcm | 18 | 959799 | 6.8X6.8X11H1cmX16.5H2cm |
| 3 | 959816 | Ø6.5X9.5Hcm | 19 | 959800 | 6.8X6.8X9.5Hcm |
| 4 | 959817 | Ø7X16.5Hcm | 20 | 959815 | 11.5X8.5X2.8Hcm |
| 5 | 959805 | Ø8X17Hcm | 21 | 959812 | 7X7X13.5Hcm |
| 6 | 959806 | Ø8X12Hcm | 22 | 959813 | 7X7X13.5H1cmX19H2cm |
| 7 | 959807 | Ø8X12Hcm | 23 | 959814 | 7X7X12Hcm |
| 8 | 959801 | Ø7.5X15Hcm | 24 | 960546 | 7X7X11.5Hcm |
| 9 | 959803 | Ø7.5X10Hcm | 25 | 960544 | 7X7X11.5Hcm |
| 10 | 959802 | Ø7.5X10.5Hcm | 26 | 960547 | 10X10X2.5Hcm |
| 11 | 960543 | 10X4.5X10Hcm | 27 | 960545 | 7X7X16.5Hcm |
| 12 | 960541 | 10X4.5X16Hcm | 28 | 960673 | Ø7.8X9.3Hcm |
| 13 | 960549 | 7X6X10Hcm | 29 | 960671 | Ø7.7X17.5Hcm |
| 14 | 960573 | 7.5X6.5X10.5Hcm | 30 | 960672 | Ø7.8X10Hcm |
| 15 | 960570 | 10.5X9X3Hcm | 31 | 960674 | Ø11X2.5Hcm |
| 16 | 960548 | 7X6X18.5Hcm | | | |

BATHROOM



11 12 13 14 15 16



17 18 19 20



21 22 23



24 25



26 27



ihouse
SINCE 1998



- 32 959679 48X6.5X9.3cm
- 33 959787 70X14X5.3Hcm
- 34 959734 Ø9.5X14X36Hcm
- 35 959733 Ø10.8X12.5X5Hcm
- 36 959732 6.8X10X10Hcm
- 37 959673 54X14.5X5Hcm
- 38 959864 53X14.5X5.3Hcm
- 39 959772 40X6.5X13.5Hcm
- 40 959771 40X6.2X13.5Hcm
- 41 959773 28X6X13.5Hcm

- 42 959735 21X6.5X21Hcm
- 43 959678 15.5X6X11Hcm
- 44 959682 12.6X9.2X18Hcm
- 45 959685 Ø17.5X6X19Hcm
- 46 959681 6X5.5X5.5Hcm
- 47 960301 Ø16.5 X 6.5 X 17 Hcm
- 48 960300 14.5 X 6.5 X 10.5 Hcm
- 49 960304 14 X 12.5 X 35.5 Hcm
- 50 960302 11 X 11 X 3.5 Hcm
- 51 960303 11 X 8 X 9.5 Hcm
- 52 960305 40 X 4 X 4.5 Hcm

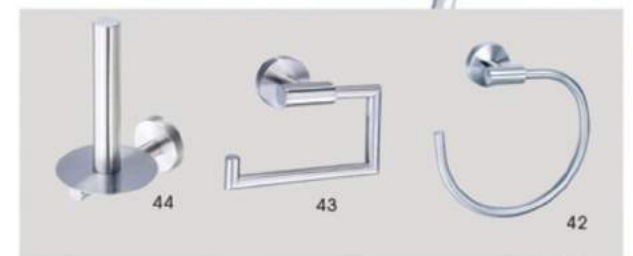

- 1 933406 10X10.5X11HX36H.cm
- 2 933407 7.5X7X18Hcm
- 3 933409 7.5X7X10.5Hcm
- 4 933408 10X10X2.5Hcm

- 5 933410 Ø9.5X13.4HX37H.cm
- 6 933411 Ø8.5X14Hcm
- 7 933413 Ø7.5X8.5Hcm
- 8 933412 12.5X8.5X2.5Hcm



BATHROOM

POLYRESIN ACCESSORIES

- 9 933417 Ø8.5X11Hcm
- 10 933416 Ø8.5X19.5Hcm
- 11 933414 Ø10X11HX37.5H.cm
- 12 933415 10.5X6.5X10Hcm
- 13 933389 Ø8X9.8Hcm
- 14 933388 Ø7X19.9Hcm
- 15 933390 12X9X2.2Hcm
- 16 933445 10.5X5X15.5Hcm
- 17 933444 7.5X7.5X11.5Hcm
- 18 933446 10.5X4.5X10.5Hcm
- 19 933448 25X9.5X2.5Hcm
- 20 933447 14X10X3Hcm
- 21 933451 Ø7X10Hcm
- 22 933449 Ø7X19.5Hcm
- 23 933450 Ø7X10Hcm
- 24 933452 13X8.5X2.5Hcm



- 25 933457 Ø7X18Hcm
- 26 933458 Ø7X10.5Hcm
- 27 933474 10X4.5X16Hcm
- 28 933475 7X5.3X19.5Hcm
- 29 933476 7.5X7.5X19.5Hcm



- 30 933435 Ø10.5X10.5HX36.5H.cm
- 31 933436 12X8.5X11.5Hcm
- 32 933437 7.5X6X10Hcm
- 33 933438 12X8.5X2Hcm



- 34 933439 Ø9.5X13.5HX36.5H.cm
- 35 933440 Ø7X17.5Hcm
- 36 933441 Ø7X9.5Hcm
- 37 933442 Ø7X9.5Hcm
- 38 933443 12X8.5X2.5Hcm



ihouse[®]
SINCE 1998



POLYRESIN ACCESSORIES

- 39 933432 8X7X17.5Hcm
- 40 933433 Ø7X10Hcm
- 41 933434 12.5X8.5X2.5Hcm
- 42 933429 7.5X6.5X17Hcm
- 43 933430 6.5X6.5X9.5Hcm
- 44 933431 12X7.5X2.5Hcm
- 45 933462 Ø8X17Hcm
- 46 933463 Ø8.5X9.5Hcm
- 47 933464 Ø8.5X9Hcm
- 48 933465 13X9.5X3Hcm
- 49 933459 7X7X13Hcm
- 50 933460 7X7X8Hcm
- 51 933461 10.5X8.5X2Hcm
- 52 933466 12X9.5X12HX36.5H.cm
- 53 933467 7.5X6.5X19Hcm
- 54 933468 8X6.5X9Hcm
- 55 933469 13X9X1.5Hcm
- 56 933470 Ø11X11.5HX35Hcm
- 57 933471 Ø7X17Hcm
- 58 933472 Ø7X11Hcm
- 59 933473 13X8.5X2.5Hcm
- 60 933427 8.5X7.5X10.5Hcm
- 61 933426 12X10X10Hcm





1



4



3



2

- 1 960359 Ø14X24X36Hcm
- 2 960358 Ø14X17.5X32Hcm
- 3 960357 Ø11.8X18.4X25Hcm
- 4 960414 Ø14X26X38.5Hcm
- 5 960355 Ø13.4X20.7X32.5Hcm
- 6 960354 Ø14X27.5X39Hcm

LED MIRROR



7



6



5

- 7 960353 Ø13.4X20.6X32.5Hcm
- 8 960433 Ø13X21X30.5Hcm
- 9 960352 Ø10.7X19X28.5Hcm
- 10 960356 Ø15X33Hcm



9



8



10





Mirror



12



13



14



15



16



17



18

- 11 960533 Ø15.5X26X43Hcm
- 12 960531 Ø13x22x35.5Hcm
- 13 960532 Ø12x18.5X34Hcm
- 14 960530 Ø12x18.5X31Hcm
- 15 960529 Ø12x19.5X26.5Hcm

- 16 960540 Ø11x18.5X28Hcm
- 17 960539 Ø8x16.5X22Hcm
- 18 960538 Ø12x16.5X22Hcm
- 19 960534 Ø14x19.5X32Hcm



19



Mirror



1



2



3



4



5



8



6



7



12



13



14



15



9



10



11



16



17



18

- | | | |
|---|---------|------------------------|
| 1 | 956169 | 19.5X13X30.5Hcm |
| 2 | 959029 | Ø14.5X38.5Hcm |
| 3 | 956168 | Ø15X25Hcm |
| 4 | 959027 | Ø14X34.5Hcm |
| 5 | 959028 | Ø10.3X34.5Hcm |
| 6 | 956172 | 15.5X13X29.5Hcm |
| 7 | 956170 | 19.5X14X28Hcm |
| 8 | 956167 | 19X2X19Hcm |
| 9 | 957040S | 14X3.6X12.7Hcm (Ø12cm) |
| | 957040M | 17X4.5X15.7Hcm (Ø15cm) |
| | 957040L | 20X5.5X19Hcm (Ø18cm) |

- | | | |
|----|---------|-------------------------------|
| 10 | 957041S | 13.4X3.6X15Hcm (11.5X14cm) |
| | 957041M | 15.7X4.6X18.7Hcm(13.7X17.5cm) |
| | 957041L | 17.8X5.5X21.5Hcm(15X20cm) |
| 11 | 957042S | 13.2X3.6X15Hcm(11X3.5cm) |
| | 957042M | 15.5X4.6X19Hcm(13.5X17.7cm) |
| | 957042L | 17.8X5.5X21.5Hcm(15X19.5cm) |
| 12 | 956256 | 18.5X8X19.5Hcm |
| 13 | 956252 | 19.7X4.8X18.5Hcm |
| 14 | 956245 | 17.1X4.3X16.6Hcm |
| 15 | 956246 | 18.5X4.5X18.1Hcm |



19



20



21



28



27



23



24



22



25

26

- 16 956258 19.4X4.5X19.2Hcm
- 17 956257 17.8X2.1X18.9Hcm
- 18 956255L 17.8X4.6X16.7Hcm
- 19 956336 18.5X4.5X18Hcm
- 20 956335L 17.5X4.5X16.5Hcm
- 21 956247 13.2X3.7X14.2Hcm
- 22 956259 16.8X6X20.3Hcm
- 23 956251 12.1X3.5X14.2Hcm

- 24 956249S 16.9XØ10X20Hcm
- 956249L 18.9XØ10X22Hcm
- 25 956248 12X3.5X14.2Hcm
- 26 956250 18.9X5.5X24Hcm
- 27 959051 Ø14X34.5Hcm
- 28 955989 Ø14X6.5Hcm





6



- | | | |
|---|---------|-----------------|
| 1 | 959031T | 9X9X33.5Hcm |
| 2 | 955991T | 9X9X7.5Hcm |
| 3 | 955990T | 12.5X10X4.2Hcm |
| 4 | 959032T | Ø18.5X33.5Hcm |
| 5 | 956510W | 11.5X9.5X5.5Hcm |



| | | |
|----|---------|-----------------|
| 6 | 956509W | 9X9X5.5Hcm |
| 7 | 956511W | 17X9.5X6.5Hcm |
| 8 | 956514W | 15X15X4.5Hcm |
| 9 | 956518W | 28.5X14X6.5Hcm |
| 10 | 956516W | 18.5X10X15.5Hcm |
| 11 | 956512W | 17.5X9X6.5Hcm |
| 12 | 956517W | 18.5X11.5X9Hcm |
| 13 | 956515W | 22X12.5X8Hcm |
| 14 | 956513W | 14X14X7Hcm |



JEWELLERY MATE

- 1 960967 Ø15x25Hcm
- 2 960966 16.5x8x23Hcm
- 3 960964 Ø11.5x14x25Hcm
- 4 960968 27x7.5x35.5Hcm
- 5 960969 26x3x40.5Hcm
- 6 960962 29x14x39Hcm



NEW

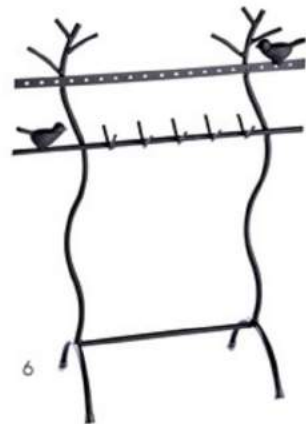



7



8



9

NEW

- 7 960965 16x12x23Hcm
- 8 960959 24.5x18x40Hcm
- 9 960961 10.5x30x26.5Hcm
- 10 960960 30x9.5x25.5Hcm
- 11 960970 30.5x10x30Hcm
- 12 960963 21x10.5x35.5Hcm

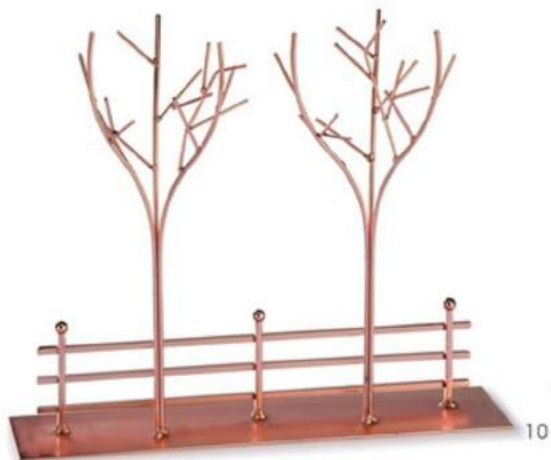

10

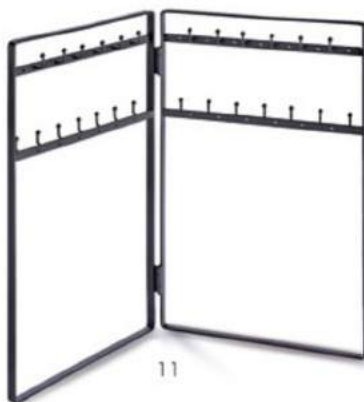

11



12

INSTALLATION



Installation with Suction or Installation with Glue

1. To install with the suction

Install on the smooth and hard surface, for example: Tiles, Glass, Plastic, Metal coating and a variety of other smooth surfaces.

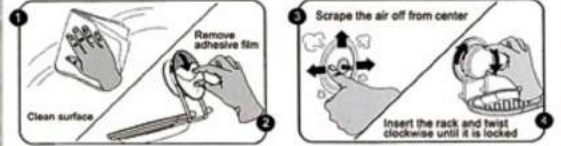

2. To install with silicone glue

Install on the rough surfaces, for example: Mosaic, Wooden, Lime, Latex paint, Wallpaper, etc.

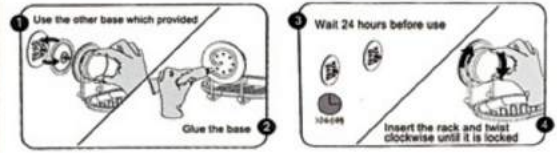

COLOR

CHROME

SATIN



No harm to wall surface,
no screw and drill required

iSUCTION

ihouse[®]
SINCE 1998

1 960747 17.5X9Hcm
2 960753 26X13X12.5Hcm
3 960752 15.5X21X9Hcm

4 960748 13X12.5X9Hcm
5 960751 8.5X10.5X14.5Hcm
6 960749 7.5X7.5X16.5Hcm
7 960750 12.5X14X5Hcm



- 1 To reuse the base: Soak the base in warm water of 40°C for 5 minutes, dry it and repeat the steps above.
- 2 Wait 2 hours after installation to ensure the product is firmly installed before use.
- 3 Not recommended for valuable and fragile items (such as clock, glasses, etc).





- | | | | | | |
|---|--------|-------------------|----|--------|-------------------|
| 1 | 960923 | 65.5X25.5X14.5Hcm | 8 | 960916 | 14X4.5X20Hcm |
| 2 | 960915 | 14X4.5X20Hcm | 9 | 960920 | 10.5X13X35.5Hcm |
| 3 | 960921 | 65.5X9X14.5Hcm | 10 | 960912 | 7X10.5X9.5Hcm |
| 4 | 960911 | 7X10.5X9.5Hcm | 11 | 960922 | 65.5X9X14.5Hcm |
| 5 | 960913 | 10.5X13X9Hcm | 12 | 960910 | 6X4X11Hcm |
| 6 | 960909 | 6X4X11Hcm | 13 | 960924 | 65.5X25.5X14.5Hcm |
| 7 | 960919 | 10.5X13X35.5Hcm | 14 | 960914 | 10.5X13X9Hcm |

iSUCTION





- | | | | | | |
|-----------|--------|-----------------|-----------|--------|-----------------|
| 15 | 960907 | 26.5X60X13Hcm | 21 | 960931 | 25X10.5X57Hcm |
| 16 | 960904 | 15X8.5X12.5Hcm | 22 | 960930 | 25X10.5X59Hcm |
| 17 | 960905 | 18X9.5X13.5Hcm | 23 | 960932 | 26.5X15.5X38Hcm |
| 18 | 960902 | 14X10.5X10Hcm | 24 | 960929 | 25X11X16.5Hcm |
| 19 | 960901 | 5.5X4.5X11.5Hcm | 25 | 960928 | 25X11X16.5Hcm |
| 20 | 960927 | 13X9X12Hcm | | | |



Fans ISUCTION

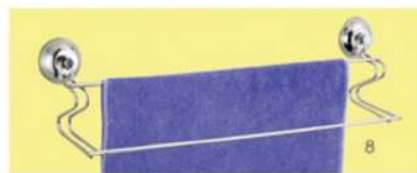

- | | | |
|---|--------|----------------------|
| 1 | 960290 | 12.1 X 7 X 15Hcm |
| 2 | 960291 | 15 X 12.7 X 12.2Hcm |
| 3 | 960289 | 24.6 X 10 X 12.4Hcm |
| 4 | 960285 | 13.3 X 11.1 X 6.6Hcm |
| 5 | 960281 | 26 X 18.5 X 8.5Hcm |
| 6 | 960337 | 25 X 5 X 22.5Hcm |
| 7 | 960278 | 35 X 10.3 X 12.4Hcm |
| 8 | 960286 | 54 X 10 X 15.8Hcm |



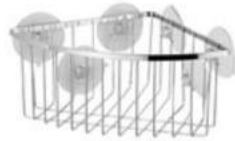

- | | | |
|----|--------|-----------------------|
| 9 | 960287 | 10.4 X 8.5 X 15.5Hcm |
| 10 | 960288 | 13 X 11.4 X 26Hcm |
| 11 | 960284 | 25.7 X 18.2 X 10.4Hcm |
| 12 | 960279 | 21.6 X 9.6 X 9.6Hcm |
| 13 | 960283 | 12.6 X 9.2 X 3Hcm |
| 14 | 960282 | 25.8 X 18 X 2.7Hcm |
| 15 | 960280 | 20.5 X 12 X 18Hcm |
| 16 | 960340 | 5 PCS / SET |



5PCS/SET



BATHROOM ACCESSORIES

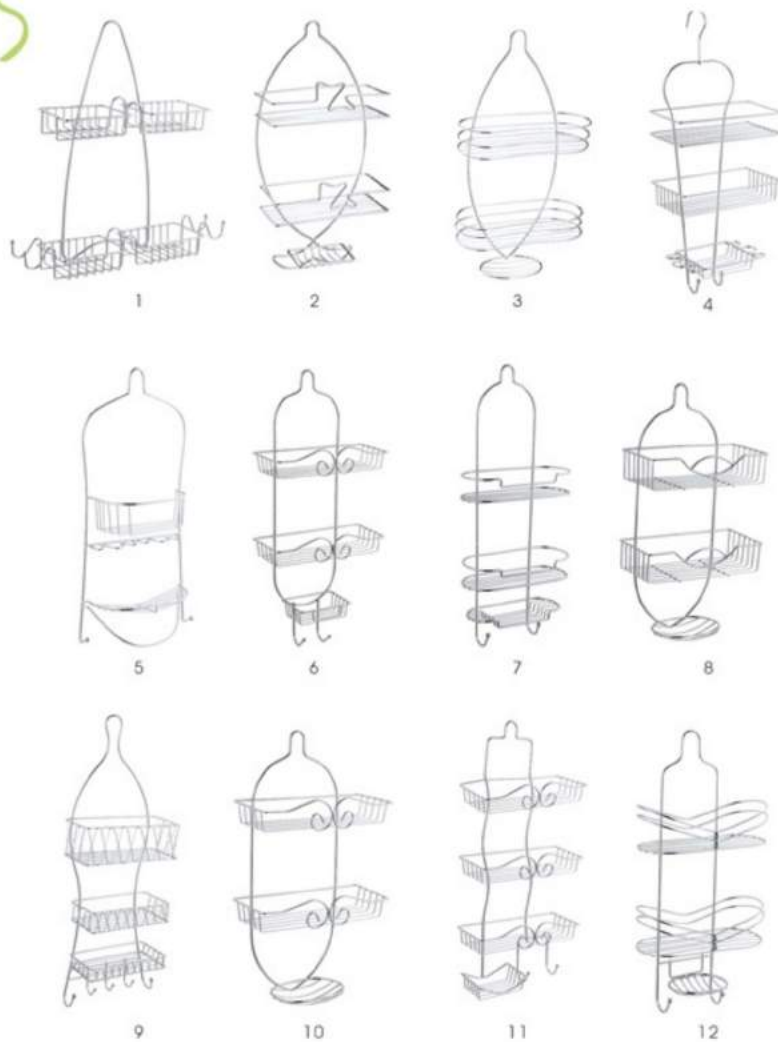

| | | | | | |
|---|--------|-----------------|----|--------|-------------------|
| 1 | 959759 | 42.5X11X43.5Hcm | 8 | 959756 | 25.5X12.5X48.5Hcm |
| 2 | 959748 | 25.5X14X56Hcm | 9 | 959750 | 25.5X12X72Hcm |
| 3 | 959749 | 28.5X12X54Hcm | 10 | 959760 | 26.5X12X49Hcm |
| 4 | 959755 | 24X14.5X61.5Hcm | 11 | 959758 | 26.5X12X61Hcm |
| 5 | 959751 | 27.5X11X63Hcm | 12 | 959752 | 28X12.5X59Hcm |
| 6 | 959754 | 26.5X12X60Hcm | 13 | 959757 | 28X11.5X62Hcm |
| 7 | 959753 | 27.5X12X67Hcm | | | |



19



18



17

| | | |
|----|--------|-------------------|
| 17 | 960094 | 27.5X20X28Hcm |
| 18 | 960091 | 29X15X35.5Hcm |
| 19 | 960089 | 25X12.5X63.5Hcm |
| 20 | 960092 | 28.5X12.5X41.5Hcm |
| 21 | 960093 | 29.5X17X58.5Hcm |
| 22 | 960090 | 17X17X64Hcm |
| 23 | 960083 | 28X12X14Hcm |



22



21



20



23



14



15



16

| | | |
|----|--------|-------------------|
| 14 | 960082 | 27X11X45Hcm |
| 15 | 960081 | 29.5X11.5X55Hcm |
| 16 | 960080 | 42.5X11.5X46.5Hcm |



1



2



3



7



6



5

- | | | |
|---|--------|-----------------|
| 1 | 959744 | ∅20X67.5Hcm |
| 2 | 959924 | 24X12.8X54.6Hcm |
| 3 | 959923 | 24X12X55Hcm |
| 4 | 959746 | ∅14.3X42.5Hcm |
| 5 | 959747 | 26.5X12.3X67Hcm |
| 6 | 959743 | 23X11X56Hcm |
| 7 | 959925 | 24.5X13.5X63Hcm |

BATHROOM ACCESSORIES



4

TOWEL RACK ON THE WALL

ihouse[®]
SINCE 1998



| | | |
|----|--------|------------------------|
| 13 | 960797 | 58.5X(17-34)X22.5Hcm |
| 14 | 960798 | 58.5X(29.5-46)X22.5Hcm |
| 15 | 960799 | 60.5X27.5X18.5Hcm |
| 16 | 960796 | 58.5X(17-34)X22.5Hcm |
| 17 | 960801 | 63X22.5X18.5Hcm |
| 18 | 960800 | 59X24.5X18.5Hcm |

STAINLESS STEEL
WIREWARE



NEW

| | | |
|----|--------|-----------------|
| 8 | 960643 | 22.5x23x37Hcm |
| 9 | 960644 | 20.5x21x37.5Hcm |
| 10 | 960647 | 22.5x23x58Hcm |
| 11 | 960646 | 32x12x36.5Hcm |
| 12 | 960645 | 22x13x37Hcm |



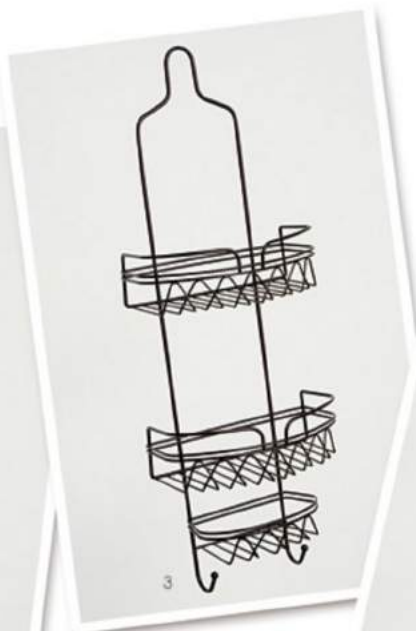

| | | | | | |
|---|--------|-----------------|---|--------|-----------------|
| 1 | 960661 | 28X12X66Hcm | 6 | 960516 | 26X14.5X62Hcm |
| 2 | 960662 | 28.5X12X65.5Hcm | 7 | 960519 | 26.5X11X61Hcm |
| 3 | 960663 | 27X13.5X74Hcm | 8 | 960518 | 23X11X53Hcm |
| 4 | 960664 | 28.5X16X60Hcm | 9 | 960506 | 30.5X16X58.5Hcm |
| 5 | 960517 | 20X12X61Hcm | | | |

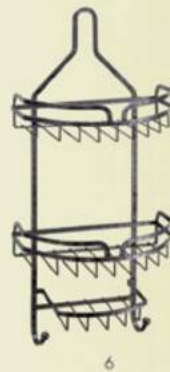



- | | | |
|----|--------|-------------------|
| 10 | 960612 | 30X12X60Hcm |
| 11 | 960615 | 30.5X16X60.5Hcm |
| 12 | 960614 | 26X16X60.5Hcm |
| 13 | 960613 | 30.5X12X61Hcm |
| 14 | 960450 | 27.8X11X61.5Hcm |
| 15 | 960449 | 33X10.2X69.5Hcm |
| 16 | 960448 | 26.8X11.5X61.5Hcm |
| 17 | 960568 | 32.5X11X60Hcm |
| 18 | 960567 | 26.5X10.5X58Hcm |
| 19 | 960566 | 29X12X56Hcm |



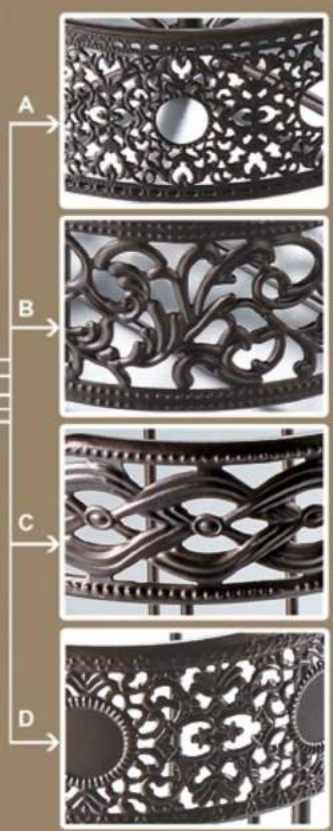

BATHROOM

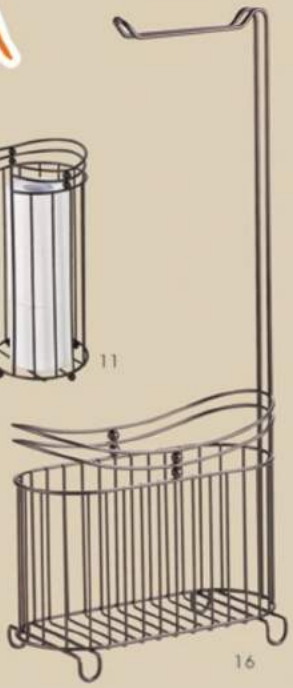
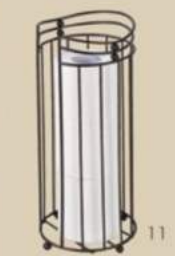
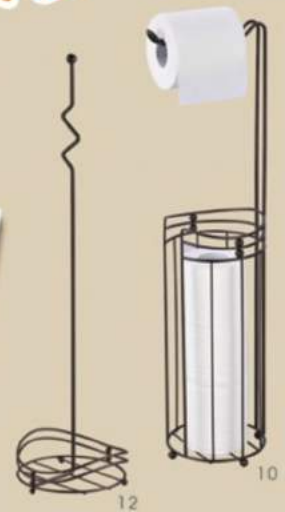

- | | | |
|----|---------|-------------------|
| 1 | 960765E | ∅14.5x64.5Hcm |
| 2 | 960762E | ∅17x64.5Hcm |
| 3 | 960766E | 30x13x65.5Hcm |
| 4 | 960771E | ∅14x37Hcm |
| 5 | 960764E | ∅14.5x37Hcm |
| 6 | 960768E | 28.5X12.5X65.5Hcm |
| 7 | 960767E | 31X12.5X65Hcm |
| 8 | 960757E | 28X12.5X66.5Hcm |
| 9 | 960726E | 29x14.5x74.5Hcm |
| 10 | 960725E | 17.5x15x64Hcm |
| 11 | 960727E | ∅15x36Hcm |
| 12 | 960724E | ∅17.5x66Hcm |
| 13 | 960760E | ∅15x35Hcm |
| 14 | 960761E | ∅14x41Hcm |
| 15 | 960770E | ∅14x41Hcm |
| 16 | 960723E | 30.5x14x66Hcm |





17



18



19



20



21

- | | | |
|----|--------|-------------------|
| 17 | 960793 | 49X15.5X24.5Hcm |
| 18 | 960790 | 37X16X31Hcm |
| 19 | 960792 | ∅17X42.5Hcm |
| 20 | 960788 | 21X21X51Hcm |
| 21 | 960795 | 27.5X26.5X78.5Hcm |
| 22 | 960794 | 49.5X37X3.5Hcm |
| 23 | 960791 | 29X4.6X17Hcm |
| 24 | 960789 | 41X14.5X47Hcm |



22



23



24



- | | | |
|---|--------|--------------------|
| 1 | 960500 | 58X20.5X165Hcm |
| 2 | 960499 | 34.5X28X100Hcm |
| 3 | 960502 | 46X17X54.5Hcm |
| 4 | 960498 | 58.3X20.5X164.5Hcm |
| 5 | 960497 | 35X18.7X100.5Hcm |
| 6 | 960501 | 46.5X17X54.5Hcm |
| 7 | 960983 | 69.5X34.5X80Hcm |
| 8 | 960984 | 38X35.5X105.5Hcm |





- 9 960445B 59.5X29.5X168.5Hcm
- 10 960446A 44X26.5X92.5Hcm
- 11 960447B 44X22.5X48.5Hcm
- 12 960445A 59.5X29.5X168.5Hcm
- 13 960446B 44X26.5X92.5Hcm
- 14 960447A 44X22.5X48.5Hcm



BATH ACCESSORIES SET

- 1 960989 4PCS/SET (18")
- 2 960995 4PCS/SET (18")
- 3 960997 4PCS/SET (18")



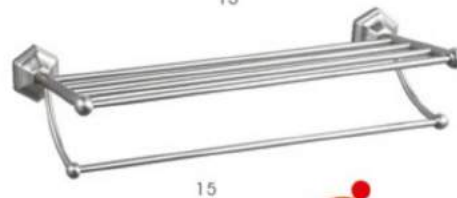
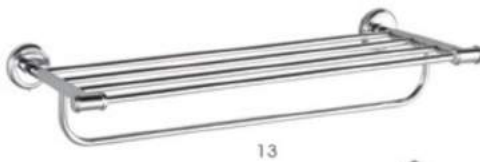
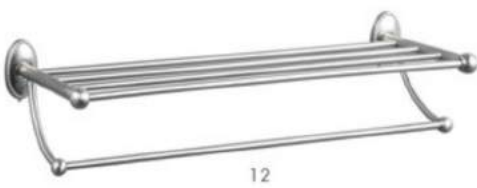

- | | | |
|----|--------|-----------------|
| 4 | 960996 | 4PCS/SET (18") |
| 5 | 960990 | 4PCS/SET (18") |
| 6 | 960994 | 5PCS/SET (18") |
| 7 | 960998 | 5PCS/SET (18") |
| 8 | 960987 | 4PCS/SET (18") |
| 9 | 960999 | 6PCS/SET (18") |
| 10 | 960992 | 5PCS/SET (18") |
| 11 | 960986 | 4PCS/SET (18") |
| 12 | 960988 | 58.5X18X14Hcm |
| 13 | 960993 | 59X19.5X11.5Hcm |
| 14 | 960985 | 60X20.5X11Hcm |
| 15 | 960991 | 61X19.5X11Hcm |



BATHROOM

- | | | |
|---|-----------|----------------|
| 1 | 961038ORB | Ø12X19X24.5Hcm |
| 2 | 961037ORB | Ø15X52Hcm |
| 3 | 961039ORB | Ø12X30Hcm |
| 4 | 961042ORB | Ø15X42Hcm |
| 5 | 961041ORB | Ø15X53Hcm |
| 6 | 961040ORB | Ø12X20.5X28Hcm |
| 7 | 961047NP | Ø15X54.5Hcm |
| 8 | 961048NP | Ø15X44Hcm |
| 9 | 961046NP | Ø12X20.5X30Hcm |





- | | | |
|----|----------|------------------|
| 10 | 961036CP | 18X13X53Hcm |
| 11 | 961035CP | Ø18X53.5Hcm |
| 12 | 961034NP | Ø12X23X26Hcm |
| 13 | 961032NP | Ø15X54Hcm |
| 14 | 961033NP | Ø12X31.5Hcm |
| 15 | 961043CP | Ø15X54Hcm |
| 16 | 961045CP | Ø12X20.5X29.5Hcm |
| 17 | 961044CP | Ø15X41Hcm |





- | | | |
|----|---------|-------------------|
| 1 | 960560B | 37.5X20X80Hcm |
| 2 | 960559A | Ø22X69.5Hcm |
| 3 | 960817 | 23.5X19.5X59Hcm |
| 4 | 960561B | 22X18X69.5Hcm |
| 5 | 960818 | 44X20X87.5Hcm |
| 6 | 960816 | 40X20X83Hcm |
| 7 | 960815 | 19.5X24X70Hcm |
| 8 | 960814 | 44.5X20X86.5Hcm |
| 9 | 960813 | 39.5X20X84Hcm |
| 10 | 960811 | 21.5X15.5X59.5Hcm |
| 11 | 960812 | 22.5X19.5X70Hcm |
| 12 | 960958 | Ø25X80Hcm |
| 13 | 960957 | Ø25X42.5X90Hcm |





23



24



14



15

16

- | | | |
|----|--------|---------------------|
| 14 | 956436 | 4PCS/SET |
| 15 | 956426 | 19X6X19Hcm |
| 16 | 956427 | 16.4X1.8X19Hcm |
| 17 | 956432 | Ø10X24.5H.X35.5H.cm |
| 18 | 956435 | 11X11X11.4H.X37H.cm |
| 19 | 960552 | 35.5XØ23.8X80Hcm |
| 20 | 960551 | Ø22XØ69.5Hcm |
| 21 | 960554 | 37.5X20X80Hcm |
| 22 | 960553 | 22X18X69.5Hcm |
| 23 | 956428 | 4PCS/SET |
| 24 | 956433 | 3PCS/SET |



17

18



19



20

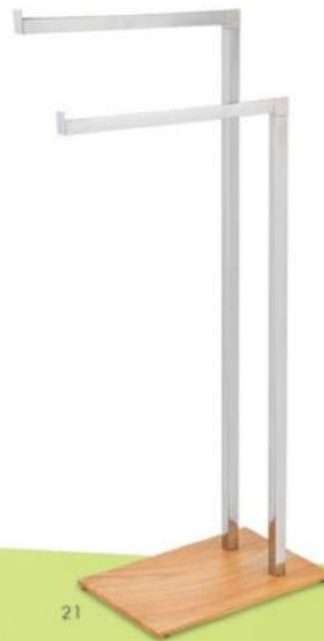

21



22



THE TENSION ONLY CADDY

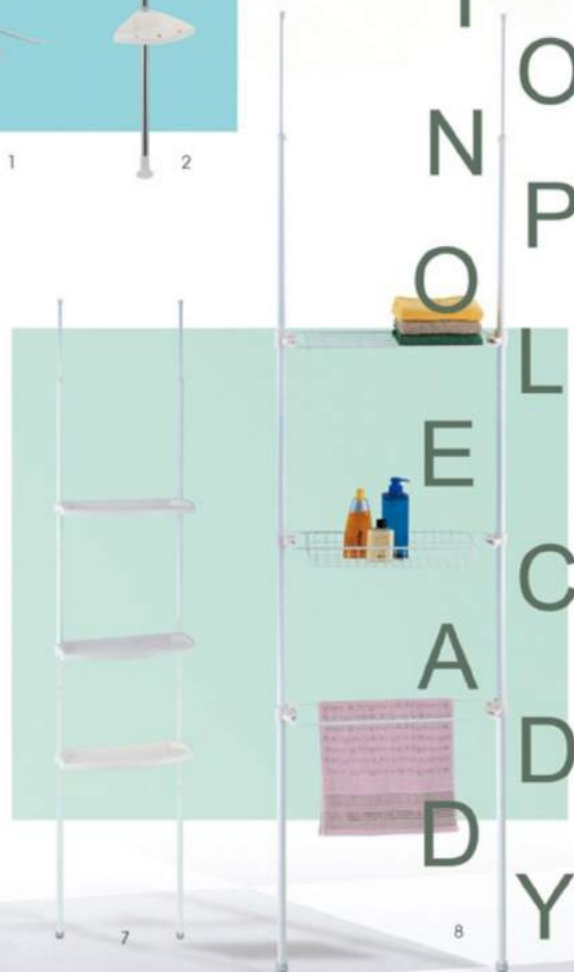
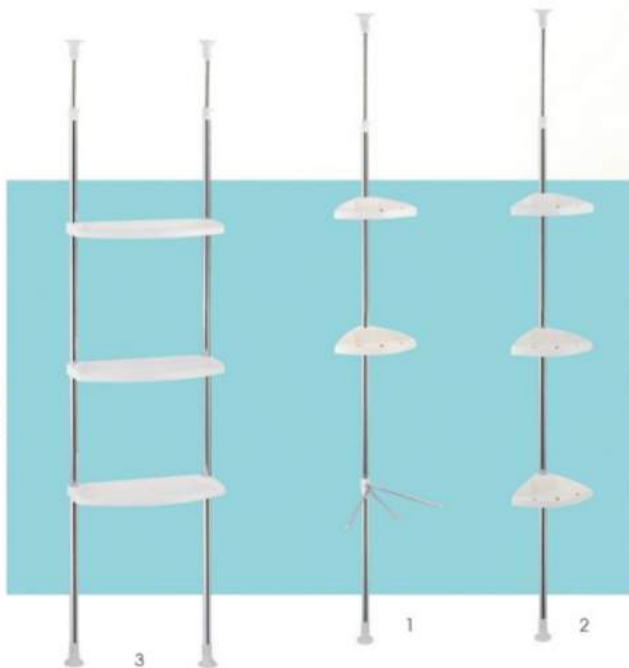

- | | | |
|----|---------|------------------------|
| 1 | 927256 | 69X21X(210-270)Hcm |
| 2 | 927259 | 30X21X(210-270)Hcm |
| 3 | 927256 | 53.5X20X(210-270)Hcm |
| 4 | 927261 | 103X40X(210-270)Hcm |
| 5 | 927101E | 30X21X(220-250)Hcm |
| 6 | 927258E | 69X21X(220-250)Hcm |
| 7 | 927256E | 52.5X20X(220-250)Hcm |
| 8 | 927253E | 57X18.5X(220-250)Hcm |
| 9 | 959247 | 22.5X16X(273-283)Hcm |
| 10 | 959244 | 21.5X21.5X(245-265)Hcm |
| 11 | 927262 | 52.5X20X(220-250)Hcm |
| 12 | 927253 | 57X18.5X(220-250)Hcm |
| 13 | 927101 | 30X21X(220-250)Hcm |
| 14 | 960728 | 32.5X40.5X(167-236)Hcm |
| 15 | 961024 | 66.5X21X(125-290)Hcm |



15



9



10



11



12



13



14



THE TENSION POLE CADDY



- | | | |
|---|--------|--------------------------|
| 1 | 960324 | 28X20.5X(218-243)Hcm |
| 2 | 960325 | 28X20.5X(268-306)Hcm |
| 3 | 959245 | 33X21.5X(197.5-257.5)Hcm |
| 4 | 959246 | 33X18.5X(197.5-257.5)Hcm |
| 5 | 960618 | 28X25.8X(229-240)Hcm |
| 6 | 960616 | 28X20X(229-240)Hcm |
| 7 | 960617 | 33X21.5X(229-240)Hcm |





8



9



10



| | | |
|----|--------|------------------------|
| 8 | 961027 | 25.5X25.5X(145-310)Hcm |
| 9 | 961026 | 29X22X(189-280)Hcm |
| 10 | 961025 | 32.5X20.5X(230-280)Hcm |
| 11 | 959055 | 25X24X(120-250)Hcm |
| 12 | 960620 | 25.5X16.5X(198-245)Hcm |
| 13 | 960619 | 25.5X16.5X(198-245)Hcm |



12



13



11



- | | | |
|----|--------|----------------|
| 1 | 956208 | 91.5 x 45.5 cm |
| 2 | 956217 | 40 x 70 cm |
| 3 | 956206 | 70 x 40 cm |
| 4 | 956201 | 40 x 70 cm |
| 5 | 956210 | 40 x 70 cm |
| 6 | 956207 | 70 x 40 cm |
| 7 | 956205 | 40 x 70 cm |
| 8 | 956199 | 35 x 75 cm |
| 9 | 956200 | 34 x 74 cm |
| 10 | 956216 | 52 x 34 cm |
| 11 | 956203 | 40 x 70 cm |
| 12 | 956212 | 34.5 x 76 cm |
| 13 | 956204 | 40 x 70 cm |
| 14 | 956213 | 38 x 89 cm |
| 15 | 956202 | 40 x 70 cm |
| 16 | 956209 | 71 x 40.5 cm |
| 17 | 956211 | 34.5 x 76 cm |
| 18 | 956215 | 55 x 54.5 cm |
| 19 | 956198 | 35 x 75 cm |
| 20 | 956214 | 53 x 53 cm |
| 21 | 956197 | 35 x 75 cm |



8



21



15



9

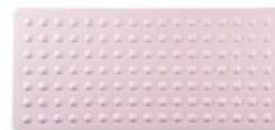

19



16



12



14



7



11



17



10



6



13



18



20



5



BATHMATS

| | | | | | |
|----|--------|---------|----|--------|----------|
| 22 | 956444 | 69x39cm | 33 | 956456 | 77x37cm |
| 23 | 956453 | 69x39cm | 34 | 956454 | 73x35cm |
| 24 | 956451 | 56x46cm | 35 | 956455 | 100x40cm |
| 25 | 956450 | 51x30cm | 36 | 956449 | 68x37cm |
| 26 | 956446 | 51x45cm | 37 | 956464 | 77x37cm |
| 27 | 956445 | 48x48cm | 38 | 956457 | 70x40cm |
| 28 | 956458 | 69x39cm | 39 | 956465 | 69x39cm |
| 29 | 956460 | 69x39cm | 40 | 956463 | 69x39cm |
| 30 | 956462 | 66x35cm | 41 | 956459 | 69x39cm |
| 31 | 956447 | 69x39cm | 42 | 956461 | 44x44cm |
| 32 | 956452 | 70x40cm | | | |





1



2

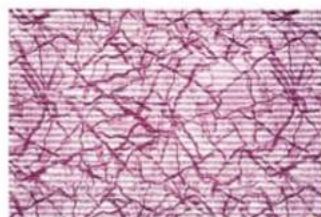

3



5



4



6

BATHMAT



| | | | | | |
|---|--------|---------|----|--------|---------|
| 1 | 956466 | 43X91cm | 8 | 956472 | 65X40cm |
| 2 | 956469 | 45X30cm | 9 | 956474 | 65X40cm |
| 3 | 956470 | 65X40cm | 10 | 956475 | 65X40cm |
| 4 | 956478 | 65X40cm | 11 | 956477 | 65X40cm |
| 5 | 956468 | 65X40cm | 12 | 956476 | 65X40cm |
| 6 | 956467 | 45X72cm | 13 | 956473 | 65X40cm |
| 7 | 956471 | 65X40cm | | | |

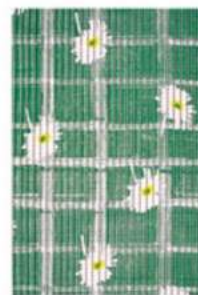

13



7



8



9



10



12



11



19



15



18



14

NEW DESIGN

- | | | |
|----|---------|--------------------------|
| 14 | 956135 | 13.5X2.3X13Hcm(2PCS/SET) |
| 15 | 959729 | 65X20X28Hcm |
| 16 | 955356E | 14X8.5X18.5Hcm(450MLX2) |
| 17 | 955357E | 7X8.5X18.5Hcm(450ML) |
| 18 | 956221 | 18.8X12X39.4Hcm |
| 19 | 956389 | 4PCS/SET |
| 20 | 955357 | 7X8.5X18.5Hcm(450ML) |
| 21 | 955356 | 14X8.5X18.5Hcm(450MLX2) |



20



21



16



17



SHOPPING LAUNDRY STORAGE



- 1 960211 36X30X95.5Hcm
- 2 960209 36X29.5X94Hcm
- 3 960208 36X29.5X94Hcm
- 4 960199 35X28X94Hcm
- 5 960202 35X28X92Hcm
- 6 960203 37X30X94Hcm

- 7 960201 40X37.5X91.5Hcm
- 8 956222 32.3X29X90.5Hcm
- 9 960206 36X29.5X91.5Hcm
- 10 960198 36X27X97Hcm
- 11 960200 36.5X29.5X91.5Hcm
- 12 960196 43X44X100.5Hcm
- 13 960210 36X28.5X92Hcm

- 14 956379 29X32.5X90.5Hcm
- 15 956378 28X37X94 Hcm
- 16 956377 28.5X36.5X94.5Hcm
- 17 960204 35X29X94Hcm
- 18 960207 36X29.5X92Hcm
- 19 960212 46.5X35X97Hcm
- 20 960197 37X28.5X96.5Hcm



- 29 956332 34X27.7X94.5HCM
- 30 956334 34X27.7X95HCM
- 31 956326 46.5X33X97.5HCM
- 32 956330 35X27.7X97HCM
- 33 956331 34X27.7X95HCM
- 34 956333 34X27.7X92HCM
- 35 956328 34X29.5X87.5HCM



- 21 956227 33X27X87.3HCM
- 22 956228 36X28X92HCM
- 23 956223 33.5X28X94.5HCM
- 24 956226 33.5X28X94.5HCM
- 25 956225 33.5X28X94.5HCM
- 26 956224 33.5X28X94.5HCM
- 27 956327 34X29.5X94HCM
- 28 956329 35X27.7X94HCM



LAUNDRY



40



41

42

- 36 960372SE ø29.5X50.5Hcm(S)
- 960372LE ø35.5X56.5Hcm(L)
- 37 960773SE ø29.5X50.5Hcm(S)
- 960773LE ø35.5X56.5Hcm(L)
- 38 959385E ø35.5X57.5Hcm
- 39 959385 ø35.5X57.5Hcm
- 40 960001 Ø34.5X48.5Hcm

- 41 960528S Ø35XØ30X45Hcm
- 960528L Ø35XØ30X58.5Hcm
- 42 960528SE Ø35XØ30X45Hcm
- 960528LE Ø35XØ30X58.5Hcm
- 43 960527S Ø29X55Hcm
- 960527L Ø35X57.5Hcm
- 44 960527SE Ø29X55Hcm
- 960527LE Ø35X57.5Hcm

- 45 957186E 30X30X50Hcm(S)
- 34X34X57Hcm(L)
- 46 957162E Ø30X54Hcm(S)
- Ø36X57Hcm(L)
- 47 906372SE Ø29.3X54Hcm(S)
- Ø35X57Hcm(L)



43

44



36

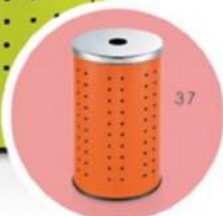

37



39



38



45



46



47



THE BATHROOM



- | | | |
|---|--------|--------------------|
| 1 | 907425 | 59X22X166Hcm |
| 2 | 907424 | 66X25.5X166Hcm |
| 3 | 907423 | 48X19X63Hcm |
| 4 | 907384 | 46X19.7X61.2Hcm |
| 5 | 907381 | 39.5X39.5X165.2Hcm |



6



7



8

ihouse®

SINCE 1998



9

| | | |
|----|---------|---------------|
| 6 | 907419 | 72X30X52Hcm |
| 7 | 907420 | 34x30x93Hcm |
| 8 | 907421E | 72X39X72.5Hcm |
| 9 | 907419E | 72X30X52Hcm |
| 10 | 907421 | 72X39X72.5Hcm |
| 11 | 907422 | 41.5X30X93Hcm |
| 12 | 907422E | 41.5X30X93Hcm |
| 13 | 907420E | 34X30X93Hcm |



10



11



12



13





iCUBE





①



②



③



④



- | | | |
|---|--------|--------------------|
| 1 | 907389 | 38.5X30X38.8Hcm |
| 2 | 907390 | 38.5X30X38.8Hcm |
| 3 | 907388 | 38.5X30X38.8Hcm |
| 4 | 907391 | 5X5X5Hcm(4PCS/SET) |



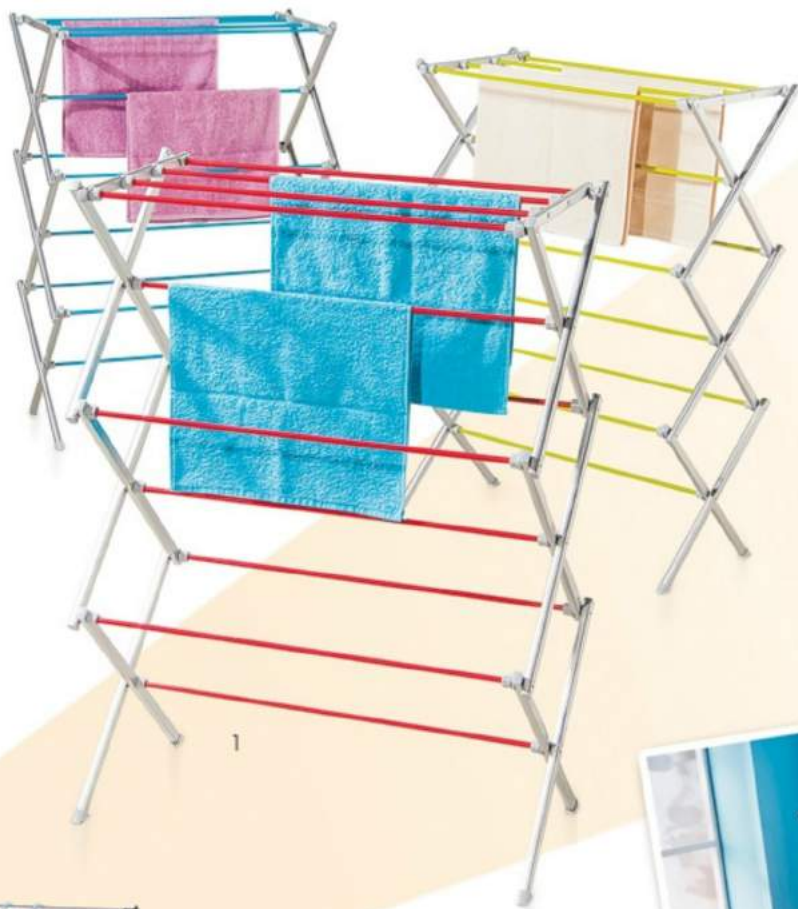

1



6



4



2



3

- | | | |
|---|---------|--------------------------|
| 1 | 947606 | 53.5X37X107Hcm |
| 2 | 959993 | 80.5X40X(94.5-168.5)Hcm |
| 3 | 959992 | 83x41x(94.5-168.5)Hcm |
| 4 | 960252E | 83x42.5x(101.5-178.5)Hcm |
| 5 | 960251E | 82.5X41.4X(102-177)Hcm |
| 6 | 960170 | 51.5X51.5X166Hcm |



HANGER KING

ihouse[®]

SINCE 1998



| | | |
|----|--------|----------------|
| 7 | 956100 | 66X55.5X129Hcm |
| 8 | 947681 | 65X65X133Hcm |
| 9 | 960627 | 65x55.5x128Hcm |
| 10 | 960955 | 74x74x167Hcm |

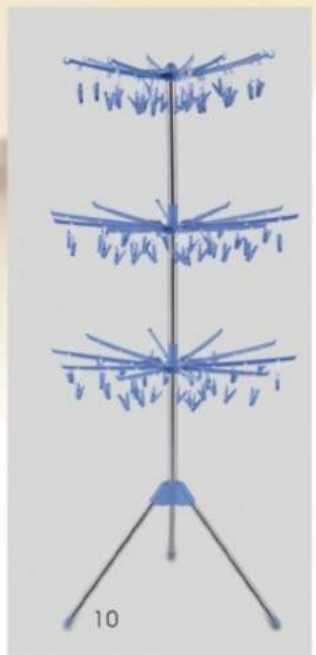

1



2



3



4



new

SHOE RACK



- | | | |
|----|---------|--------------------|
| 1 | 960628 | 56X48X107Hcm |
| 2 | 960565 | 57X49.5X113.5Hcm |
| 3 | 960893 | 31X19X(220~250)Hcm |
| 4 | 960894 | 31X19X(220~250)Hcm |
| 5 | 960629 | 31X31X(223~240)Hcm |
| 6 | 959250D | Ø27X30.5X81.5Hcm |
| 7 | 959251 | Ø27X30.5X146Hcm |
| 8 | 959250B | Ø27X30.5X81.5Hcm |
| 9 | 959250A | Ø27X30.5X81.5Hcm |
| 10 | 959996 | Ø27X293Hcm |
| 11 | 959996E | Ø27X293Hcm |

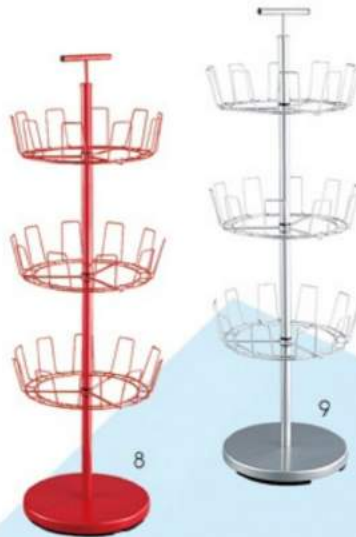

colour options





SHOE RACK



- 1 960744 73.5X25.5X89.5Hcm
- 2 960743 67.5X31X46.5Hcm
- 3 960052 58X26X63.5Hcm
- 4 960023E 60X26X71.5Hcm
- 5 959377 63X27X80.5Hcm
- 6 960322S 69X30X76Hcm
960322L 91X30X75Hcm
- 7 960802 71.5X23.5X60Hcm



USE AS YOU WANT

ihouse[®]

SINCE 1998



| | | |
|----|--------|-------------------|
| 8 | 960419 | 51.5X18.5X68.5Hcm |
| 9 | 960418 | 51.5X18.5X37Hcm |
| 10 | 960416 | 51.5X18.5X33.5Hcm |
| 11 | 960417 | 51.5X18.5X63.5Hcm |
| 12 | 959999 | 68X25X30.5Hcm |
| 13 | 960745 | 64X27X20Hcm |
| 14 | 960746 | 71X23.5X31.5Hcm |



9



8



10



11



multipurpose storage



13



14



12





SHOE & BOOT ORGANIZER

- 1 960694 49.5X13X142Hcm
- 2 960693 68X34X113.5Hcm
- 3 960692 68X34X89Hcm
- 4 960690 69X40X51.5Hcm
- 5 960695 69X13X142Hcm



OTD

ihouse[®]
SINCE 1998

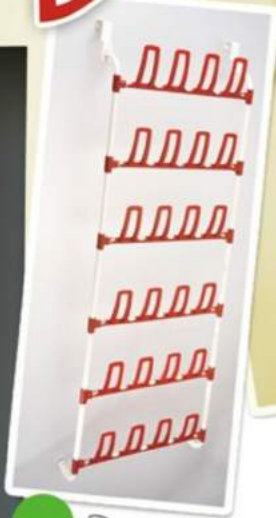

colour options

- | | | |
|----|--------|-----------------------|
| 6 | 960298 | 67.5 X 18 X 151 Hcm |
| 7 | 960295 | 47.5 X 18 X 101 Hcm |
| 8 | 960297 | 67.5 X 18 X 101 Hcm |
| 9 | 960296 | 47.5 X 18 X 150.5 Hcm |
| 10 | 960292 | 49 X 20.4 X 68 Hcm |
| 11 | 960294 | 49 X 20.4 X 100.7 Hcm |
| 12 | 960293 | 49 X 20.4 X 93 Hcm |
| 13 | 960339 | 49 X 20.4 X 137 Hcm |

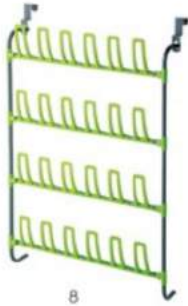
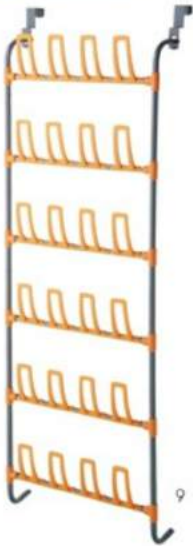



1



2



3

- | | | | |
|---|---------|----|---------|
| 1 | 956590W | 7 | 956589W |
| 2 | 956596W | 8 | 956597W |
| 3 | 956594W | 9 | 956593W |
| 4 | 956588W | 10 | 956592W |
| 5 | 956595W | 11 | 956591W |
| 6 | 956598W | | |

BATHROOM FAMILY

18PCS Bathroom Set :

- 12PCS Shower Curtain Hooks
- 4PCS Plastic Bathroom Tools
- 1PC Mat
- 1PC PEVA Shower Curtain (SIZE: 180X180cm)
- Packing: Show Box

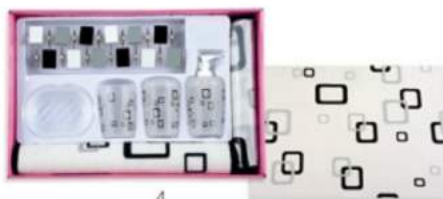

4



5



6



10



7



8



11



9



SHOWER CURTAIN WITH HOOKS

12PCS HOOKS + 1PC PEVA SHOWER CURTAIN

ihouse[®]
SINCE 1998



12



13



18

- 12 960883W
- 13 960886W
- 14 960888W
- 15 960882W
- 16 960884W
- 17 960887W
- 18 960885W
- 19 960881W

PEVA



15



16



17



19



14

POLYESTER

12PCS HOOKS + 1PC POLYESTER SHOWER CURTAIN



20



21



22



24



23

- 20 960880W
- 21 960879W
- 22 960876W
- 23 960877W
- 24 960878W





- 1 960859W 6X5X7Hcm
- 2 960861W 3X5.5X6.5Hcm
- 3 960854W 3X5X6.5Hcm
- 4 960855W 3X5.5X6Hcm
- 5 960856W 3X5.5X6Hcm
- 6 960860W 3X4.5X6.5Hcm
- 7 960862W 3X5.5X6.5Hcm
- 8 960872W 3X5X7Hcm

- 9 960868W 2.5X5X7Hcm
- 10 960857W 2.5X5X7Hcm
- 11 960858W 2.5X5X7Hcm
- 12 960900W 4X5X6.5Hcm
- 13 960866W 3.5X5X6.5Hcm
- 14 960863W 3X4.5X6.5Hcm
- 15 960871W 3X4.5X7Hcm
- 16 960933W 3X4.5X7Hcm



- 17 960864W 3X5X6.5Hcm
- 18 960874W 3.5X5X7Hcm
- 19 960865W 3.5X5X7Hcm
- 20 960873W 3.5X5X7Hcm
- 21 960869W 4X5X6.5Hcm
- 22 960899W 3X5.5X6.5Hcm

- 23 960898W 3.5X5.5X6.5Hcm
- 24 960875W 3.5X5X7Hcm
- 25 960897W 3.5X5.5X6.5Hcm
- 26 960870W 3.5X5.5X6.5Hcm
- 27 960867W 3X5X6.5Hcm





28



29



30

ihouse[®]
SINCE 1998



33

LAUNDRY

- 28 978105W Ø35X45Hcm
- 29 978104W Ø36X44Hcm
- 30 978106W Ø35X44Hcm
- 31 978110W Ø33X43Hcm
- 32 978112W Ø40X50Hcm
- 33 978107W 54X37X72Hcm
- 34 978109W Ø33X43Hcm
- 35 978113W Ø33X43Hcm
- 36 978114WS Ø33X45Hcm
- 978114WL Ø40X48Hcm
- 37 978111W Ø35X44Hcm
- 38 978117W 40X33X55Hcm
- 39 978116W 40X19X55Hcm
- 40 978120W 64X32X76Hcm
- 41 978122W 24X34X65Hcm
- 42 978119W 63X32X54Hcm
- 43 978121W 35X35X60Hcm
- 44 978118W 33X32X54Hcm



31

32



34

35

36

37



41



43



40



38

39



42



44





LAUNDRY



| | | |
|---|---------|-----------------|
| 1 | 978021 | 34X34X63.5Hcm |
| 2 | 978020 | 76X26X46.5Hcm |
| 3 | 978083 | 30X29.5X54.5Hcm |
| 4 | 978080 | 25.5X25X62.5Hcm |
| 5 | 978081 | 52X25X62.5Hcm |
| 6 | 978082 | 77.5X25X62.5Hcm |
| 7 | 978052S | 29X29X46Hcm |
| | 978052L | 36.5X36.5X58Hcm |





| | | |
|----|---------|-----------------|
| 8 | 917568 | 84X48.5X81Hcm |
| 9 | 960717 | 59X42X60Hcm |
| 10 | 960689 | 83.5X22X81.5Hcm |
| 11 | 959968E | 55.5X21X86Hcm |
| 12 | 959969E | 36.5X26X65.5Hcm |
| 13 | 956101 | 47.5X33X56Hcm |
| 14 | 960428 | 40X38X77Hcm |
| 15 | 960738 | 38.5X26X86Hcm |
| 16 | 960462 | 41X27.5X88Hcm |
| 17 | 959990 | 57X43.5X86Hcm |
| 18 | 961023 | 42X16X97Hcm |



STORAGE STOOL



- | | | |
|---|----------|-------------|
| 1 | 978100W | 76X38X36Hcm |
| 2 | 978099W | 76X38X36Hcm |
| 3 | 978103WS | 30X30X30Hcm |
| | 978103WL | 38X38X36Hcm |
| 4 | 978102WS | 30X30X30Hcm |
| | 978102WL | 38X38X36Hcm |



| | | |
|----|----------|-----------------|
| 5 | 978101WS | 30X30X30Hcm |
| | 978101WL | 38X38X36Hcm |
| 6 | 978086W | 67X33X33Hcm |
| 7 | 978085WS | 33X33X33Hcm |
| | 978085WL | 37X37X37Hcm |
| 8 | 978096WS | 33X33X33Hcm |
| | 978096WL | 37X37X37Hcm |
| 9 | 978090WS | 33X33X33Hcm |
| | 978090WL | 38X38X36Hcm |
| 10 | 978089W | 67X33X33Hcm |
| 11 | 978087WS | 33X33X33Hcm |
| | 978087WL | 38X38X38Hcm |
| 12 | 978115W | 40.5X40.5X40Hcm |



FOLDING OTTOMAN

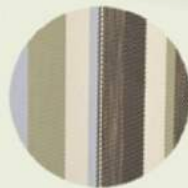



- | | | |
|---|---------|-------------|
| 1 | 978006 | 99x26.5Hcm |
| 2 | 978005 | 78x40Hcm |
| 3 | 978016 | 45.5x150Hcm |
| 4 | 978015 | 56x134.5Hcm |
| 5 | 978002S | 59X87CM |
| | 978002M | 59X105CM |
| | 978002L | 59X126CM |
| 6 | 978003 | 148x45Hcm |
| 7 | 978004 | 135X56.5Hcm |

MY ORGANIZER



MY ORGANIZER



9



8



10



11



- | | | |
|----|--------|-----------------|
| 8 | 978001 | 30x29.5x97Hcm |
| 9 | 978010 | 35x15x124Hcm |
| 10 | 978017 | 91x55.5x18.5Hcm |
| 11 | 978000 | 32x16x97Hcm |



2



3



4



5



6



8

MY ORGANIZER

- | | | |
|---|--------|------------------|
| 1 | 978011 | 29.5x29.5x118Hcm |
| 2 | 978012 | 44x132Hcm |
| 3 | 978013 | 50x140Hcm |
| 4 | 978014 | 55x134Hcm |
| 5 | 978007 | 28.5x13.5x122Hcm |
| 6 | 978008 | 28.5x13.5x122Hcm |
| 7 | 978032 | 130x15x51Hcm |
| 8 | 978031 | 80x15x51Hcm |



MY ORGANIZER

HANDBAG ORGANIZER

ihouse[®]
SINCE 1998



- 9 978084 30.5x121.5Hcm
- 10 978033 9x111.5Hcm
- 11 978034 34.5x41.5x68Hcm
- 12 978035 33x32.5x145Hcm
- 13 978095 72.5X42Hcm
- 14 978094 64X42.5Hcm



BACK SEAT ORGANIZER



ORGANIZER



| | | | | | |
|---|---------|--------------|----|---------|-----------------|
| 1 | 978036S | 40.5X49.5Hcm | 9 | 978049 | 45X147.5Hcm |
| 2 | 978036L | 40.5X75Hcm | 10 | 978038 | 57.5X125.5Hcm |
| 3 | 978044 | 44X103Hcm | 11 | 978057 | 58X131.5Hcm |
| 4 | 978050 | 45X114Hcm | 12 | 978039 | 31X30X140Hcm |
| 5 | 978056 | 41.5X107Hcm | 13 | 978041 | 28X17X72Hcm |
| 6 | 978055 | Ø32X115Hcm | 14 | 978053S | 38X28X18Hcm |
| 7 | 978054 | Ø32.5X71Hcm | | 978053L | 42.5X31X18Hcm |
| 8 | 978043 | 56X15X17Hcm | 15 | 978051 | 30.5X30.5X30Hcm |





- 16 960741 81X42X143.5Hcm
- 17 960697 (104-167.5)X55X(129.5-168)Hcm
- 18 960698 (89.5-132)X53X170Hcm
- 19 960700 90X45X170.5Hcm
- 20 960707 134X45X180.5Hcm
- 21 960699C 91X46X170.5Hcm
- 22 960699 90X45X169.5Hcm
- 23 961028 120X45X179.5Hcm
- 24 961012 (142-215.5)X35X180.5Hcm



shelving



Ø25
MM



- 1 960706 90X45X201.5Hcm
- 2 960709 90X45X162Hcm
- 3 960708 91X36X139Hcm



shelving



Ø22
MM

- 4 960712 90X35X90Hcm
- 5 960713 60X35X90Hcm
- 6 960715 75X36X138Hcm
- 7 960711 90X45X161Hcm





- 8 960704 91X36X161Hcm
- 9 960705 90X45X161Hcm
- 10 960710 90X45X200Hcm
- 11 960716 80X30X141.5Hcm
- 12 960714 80X30X76.5Hcm
- 13 960701 75X36X71.5Hcm
- 14 960702 75X36X139Hcm
- 15 960703 91X36X80.5Hcm

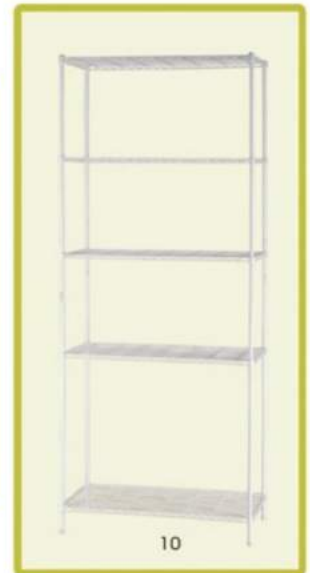
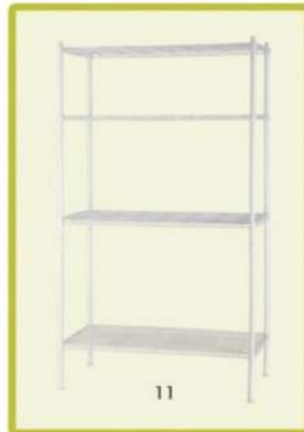

- 1 960675 82X29X56.5Hcm
- 2 960630 82X29X22Hcm
- 3 960733 82X32X88Hcm
- 4 960735 82X32X113.5Hcm
- 5 956631 82X32X30Hcm



SHOE & BOOT ORGANIZER





6



7



8

FOR YOUR SHOE & BOOT



11



Hold 18 pairs of shoes



Hold 3 pairs of tall boots & 9 pairs of shoes



Hold 3 pairs of mid-calf boots & 12 pairs of shoes

| | | |
|----|---------|-----------------|
| 6 | 960659 | 80x34x59Hcm |
| 7 | 960657 | 80x34x59Hcm |
| 8 | 960658 | 80x34x59Hcm |
| 9 | 960262S | 69.5x30.5x76Hcm |
| 10 | 960262L | 91x30x75.5Hcm |
| 11 | 978065 | 59x39x105.5Hcm |



9



10



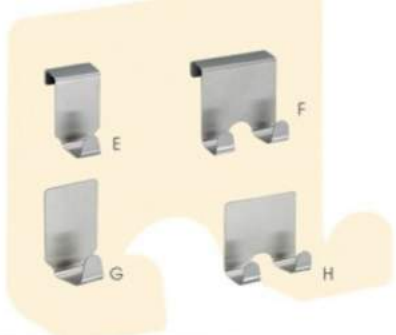

- A 959138 30X12.5X4.5Hcm
- B 959139 (23-35)X6.5X5.6Hcm
- C 959135 23.5X5X8Hcm
- D 959137 23.5X10X9.5Hcm
- E 959134 4X4.5X6.5Hcm
- F 959136 6.8X4.5X6.5Hcm
- G 959131 4X2.5X6Hcm
- H 959133 6.8X2.5X6Hcm
- I 959132 23.5X4.5X6Hcm

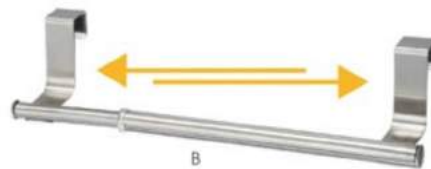

HOOK



GOOD COLLECTION

- 1 960030 (1E+1F+1C)
- 2 960027 (1H+1G)
- 3 960032 (Fx2)
- 4 960028 (1E+1F)
- 5 960025 (Ex2)
- 6 960029 (Hx2)
- 7 960026 (Gx2)
- 8 960031 (1H+1G+1I)





9
colour options

Multipurpose Hook

| | | | | | |
|----|---------|-------------------|----|---------|-----------------|
| 9 | 960120 | Ø6.1X14.5X7.5cm | 17 | 960511 | 32.5X8.5X13Hcm |
| 10 | 960084 | 21X12.5X27Hcm | 18 | 960514E | 45.5X13.5X27Hcm |
| 11 | 960168 | 33.5X15.5X39.5Hcm | 19 | 960514 | 45.5X13.5X27Hcm |
| 12 | 960169 | 33X15X28Hcm | 20 | 960513E | 39X13.5X23.5Hcm |
| 13 | 959230 | 40X7.5X15.5Hcm | 21 | 960513 | 39X13.5X23.5Hcm |
| 14 | 959229 | 30X6.5X13.2Hcm | 22 | 960574E | 32.5X10X12Hcm |
| 15 | 937213 | 30.5X6X17Hcm | 23 | 960574 | 32.5X10X12Hcm |
| 16 | 960511E | 32.5X8.5X13Hcm | | | |

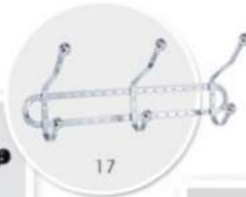
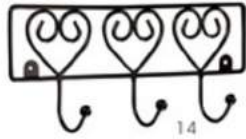
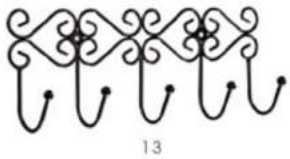

PURPOSE STORAGE



| | | |
|----|---------|-------------------|
| 1 | 960043 | 31.5X24X25Hcm |
| 2 | 960044 | 31.5X24X25Hcm |
| 3 | 960042S | 36.5X18X32Hcm |
| 4 | 960003 | 18.5X16.5X17Hcm |
| 5 | 960042L | 37X25X34.5Hcm |
| 6 | 960036L | 45.5X22X20.5Hcm |
| 7 | 960036S | 36.5X18X18Hcm |
| 8 | 960040L | 32X19.5X20.3Hcm |
| 9 | 960040S | 22.5X16.5X15.5Hcm |
| 10 | 960256 | 35X14X31Hcm |
| 11 | 960255 | 30X11X26Hcm |
| 12 | 960254 | 25.5X17X24.5Hcm |
| 13 | 960253 | 21.5X15X15.5Hcm |





15



16

ihouse[®]
SINCE 1998

- | | | |
|----|--------|-----------------|
| 14 | 959058 | (61-87)X25X4Hcm |
| 15 | 956319 | 36x30x67Hcm |
| 16 | 956244 | 30x21.5x45Hcm |
| 17 | 956320 | 30x21.5x67Hcm |
| 18 | 956243 | 36x30x45Hcm |
| 19 | 956133 | 34x25x64.5Hcm |
| 20 | 955878 | 47.5x35x23.5Hcm |
| 21 | 955877 | 42x32.5x22.5Hcm |



18



17



21



20

MULTI-PURPOSE
SHELF



14



19



Place mat & Cup mat



1



SIZE: 10X10cm



2

PLACE
MAT



CUP
MAT

| | | |
|---|---------|-----------|
| 1 | 956547W | 42X27.5cm |
| 2 | 956546W | 42X27.5cm |
| 3 | 956556W | 42X27.5cm |
| 4 | 956553W | 42X27.5cm |
| 5 | 956554W | 42X27.5cm |
| 6 | 956552W | 42X27.5cm |

| | | |
|----|---------|-----------|
| 7 | 956548W | 42X27.5cm |
| 8 | 956557W | 42X27.5cm |
| 9 | 956555W | 42X27.5cm |
| 10 | 956551W | 42X27.5cm |
| 11 | 956549W | 42X27.5cm |
| 12 | 956550W | 42X27.5cm |



3



4



5



6



7



8



9



10



11



12



13



14



15



16



17



18



13 956540W 42X27.5cm
14 956544W 42X27.5cm
15 956545W 42X27.5cm
16 956543W 42X27.5cm
17 956541W 42X27.5cm
18 956542W 42X27.5cm

19 956536W 42X27.5cm
20 956535W 42X27.5cm
21 956539W 42X27.5cm
22 956537W 42X27.5cm
23 956534W 42X27.5cm
24 956538W 42X27.5cm



19



20



21



22



23



24





Placemat

- 1 956526W 30X45cm
- 2 956530W 30X45cm
- 3 956524W 30X45cm
- 4 956527W 30X45cm
- 5 956531W 30X45cm

- 6 956529W 30X45cm
- 7 956523W 30X45cm
- 8 956528W 30X45cm
- 9 956522W 30X45cm



3



4



5



6



7



8



9



- 10 956559W 30X45cm
- 11 956562W 30X45cm
- 12 956558W 30X45cm
- 13 956569W 30X45cm
- 14 956561W 30X45cm
- 15 956560W 30X45cm
- 16 956572W 30X45cm

- 17 956565W 30X45cm
- 18 956568W 30X45cm
- 19 956570W 30X45cm
- 20 956571W 30X45cm
- 21 956566W 30X45cm
- 22 956567W 30X45cm

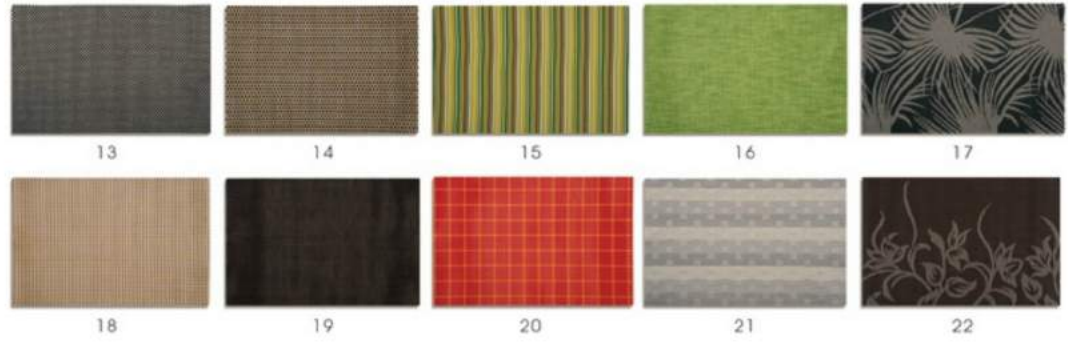

My Canister

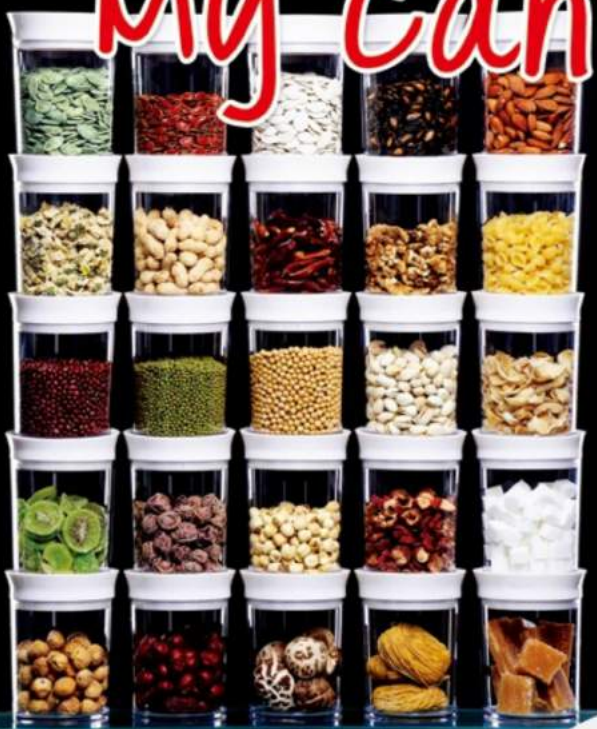

6



5



- 1 960384 38X12.5X22.5 Hcm
- 2 960383 38X12.5X22.5 Hcm
- 3 960385 38X12.5X39 Hcm
- 4 960386 38X12.5X39 Hcm
- 5 960421 38X12.5X22.5 Hcm
- 6 960422 38X12.5X39 Hcm



1



2



3



4





- | | | |
|----|---------|---------------|
| 7 | 956126 | 12X12X14.5Hcm |
| 8 | 956124 | 12X12X14.5Hcm |
| 9 | 956123 | 3PCS/SET |
| 10 | 956173B | Ø11X14.5Hcm |
| 11 | 956173A | Ø11X14.5Hcm |
| 12 | 956173C | Ø11X14.5Hcm |
| 13 | 956163 | Ø11X14.5Hcm |
| 14 | 959862S | 10X10X10Hcm |
| | 959862L | 10X10X12.5Hcm |
| 15 | 959861S | 10X10X9.5Hcm |
| | 959861L | 10X10X12Hcm |
| 16 | 959863S | 10X10X10Hcm |
| | 959863L | 10X10X12.5Hcm |
| 17 | 956162 | 12X12X14Hcm |
| 18 | 956136 | 3PCS/SET |
| 19 | 956187 | Ø11X14.5Hcm |
| 20 | 956380A | 3PCS/SET |
| 21 | 956380B | 3PCS/SET |
| 22 | 956563 | 3PCS/SET |



My Canister



1 3



4



13



2 5



12 14



15



11 10

- 1 959858S Ø10.5X8Hcm
- 959858M Ø10.5X11Hcm
- 959858L Ø10.5X13.5Hcm
- 959858XL Ø10.5X16Hcm
- 2 959859S Ø10.5X8Hcm
- 959859M Ø10.5X11Hcm
- 959859L Ø10.5X13.5Hcm
- 959859XL Ø10.5X16Hcm
- 3 959857S Ø10.5X8Hcm
- 959857M Ø10.5X11Hcm
- 959857L Ø10.5X13.5Hcm
- 959857XL Ø10.5X16Hcm
- 4 959856S Ø10.5X7.5Hcm
- 959856M Ø10.5X11.5Hcm
- 959856L Ø10.5X14Hcm
- 959856XL Ø10.5X16.5Hcm
- 5 959860S Ø10.5X8Hcm
- 959860M Ø10.5X11Hcm
- 959860L Ø10.5X13.5Hcm
- 959860XL Ø10.5X16Hcm

- 9 960138 2PCS/SET
- 10 959462E Ø9.5XØ11X13Hcm
- 11 959462 Ø9.5XØ11X13Hcm
- 12 960371 Ø11X17Hcm
- 13 960371SE Ø11X17Hcm
- 14 960372 Ø11X17Hcm



9

- 15 960465S 13XØ10X9Hcm
- 960465M 13XØ10X12Hcm
- 960465L 13XØ10X14Hcm
- 960465XL 13XØ10X16Hcm



6



7

- 6 959484 3PCS/SET
- 7 959487 3PCS/SET
- 8 959492 3PCS/SET



8



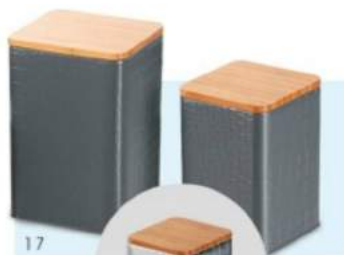

17

ihouse[®]
SINCE 1998



16

MULTI -PURPOSE STORAGE

- 16** 960521E 2PCS/SET
Ø11X14Hcm (S)
Ø13X15Hcm (L)
- 17** 960487E 2PCS/SET
14X14X21Hcm (S)
17.5X15.2X26Hcm (L)
- 18** 960486E 3PCS/SET
Ø11X14.4Hcm



19

- 19** 960571E 2PCS/SET
Ø13X15Hcm (S)
Ø19X20.5Hcm (L)
- 20** 960572E 4PCS/SET
Ø13X15Hcm (3PCS)
42.5X20.8X15.5Hcm (1PC)
- 21** 960489SE 31X17.5X19.5Hcm
- 22** 960489LE 42.5X20.8X15.5Hcm



18



20



21



22





MULTI-PURPOSE STORAGE



colour options



| | | |
|----|---------|-------------------|
| 1 | 960366 | 5PCS/SET |
| 2 | 960364 | 5PCS/SET |
| 3 | 960365 | 5PCS/SET |
| 4 | 960363 | 5PCS/SET |
| 5 | 960380B | 5PCS/SET |
| 6 | 960432 | 3PCS/SET |
| 7 | 960431 | 3PCS/SET |
| 8 | 960046 | 37X18X32Hcm |
| 9 | 960045 | 32.5X18.5X31.5Hcm |
| 10 | 959961 | 16.5X23X17.5Hcm |
| 11 | 959962 | 18.5X15X15Hcm |
| 12 | 960041 | 23.5X16X26Hcm |





21



24

colour options



22



23



- 13 960039S 31X18.5X17.5Hcm
- 14 960039L 41X22X20.5Hcm
- 15 960037L 29.5X23.5X32Hcm
- 16 960037S 26X21X22Hcm
- 17 960038L Ø17X27.5Hcm
- 18 960038S Ø14X23Hcm
- 19 960035L 24X17.5X29Hcm
- 20 960035S 23X16X26Hcm
- 21 960387 3PCS/SET
- 22 960381A 5PCS/SET
- 23 960404 3PCS/SET
- 24 960775 3PCS/SET



13



14



17



18



15



16

- 25 960805 5PCS/SET
- 11.5X11.5X16.5Hcm (S)
- 14X14X18.5Hcm (M)
- 28.5X21X33.5Hcm (L)
- 26 960804 5PCS/SET
- Ø11.5X14Hcm (S)
- Ø14.5X18.5Hcm (M)
- Ø23X31.5Hcm (L)

19



20

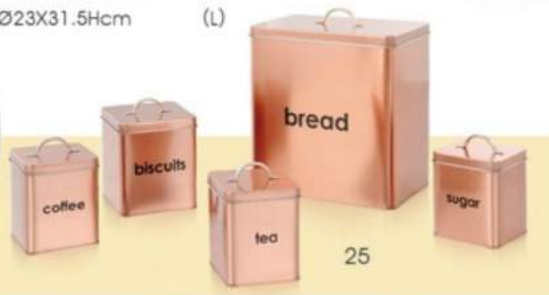

25



26





1



3



4



2



5



6



7

8

| | | | | | |
|---|--------|------------------|---|----------|-----------|
| 1 | 960807 | 15XØ11.5X11.5Hcm | 5 | 960977LE | Ø14X15Hcm |
| 2 | 960806 | 14.5XØ11X12Hcm | 6 | 960977SE | Ø11X15Hcm |
| 3 | 960808 | 11X11X16.5Hcm | 7 | 960977L | Ø14X15Hcm |
| 4 | 960809 | Ø13.5X17Hcm | 8 | 960977S | Ø11X15Hcm |



10



9

KITCHEN TOOLS
MAID



11

| | | |
|----|---------|-----------------|
| 9 | 956174A | Ø12.5X16.5HCM |
| 10 | 960338 | Ø12X16.5HCM |
| 11 | 960460E | Ø12X16.5HCM |
| 12 | 960461E | Ø9.5X12.5HCM |
| 13 | 960461 | Ø9.5X12.5HCM |
| 14 | 960460 | Ø12X17HCM |
| 15 | 956128 | 11.5X11.5X13HCM |
| 16 | 956129 | 11.5X11.5X13HCM |
| 17 | 956174C | Ø12.5X16.5HCM |
| 18 | 956174B | Ø12.5X16.5HCM |



17



18



15



16



12

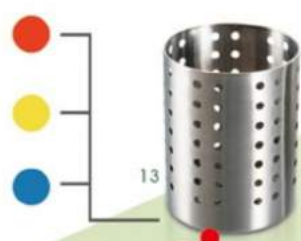

13



14

MY SIMPLE STORAGE



3



1



2

colour options



4



- | | | |
|---|---------|------------------|
| 1 | 956149 | 42.5X23.5X11Hcm |
| 2 | 956119 | 31X27X12.5Hcm |
| 3 | 960033E | Ø26X75Hcm |
| 4 | 956130 | 28X24X14.5Hcm |
| 5 | 956120L | Ø26X11Hcm |
| 6 | 956188 | 3PCS/SET |
| 7 | 956442 | 35.5X26.2X5.3Hcm |
| 8 | 956441 | 15.5X8X11.5Hcm |



7



6



5



8





MY FASHION STORAGE

9 956440 11X10X13Hcm
10 956443 Ø36.5X3Hcm

11 956396 38.5X17X3Hcm
12 956397 Ø26X7.5Hcm
13 956398 34.5XØ31.5X14.5Hcm



14 956504W 4PCS/SET
11.5X11X5.5Hcm(S)
13.5X13X6.5Hcm(M)
20X19.5X9.5Hcm(L)
25.5X25X12.5Hcm(XL)

15 956503W 4PCS/SET
11.5X11X5.5Hcm(S)
13.5X13X6.5Hcm(M)
20X19.5X9.5Hcm(L)
25.5X25X12.5Hcm(XL)

16 956502W 2PCS/SET
19.5X16.5X7Hcm(S)
26X23.5X12Hcm(L)
17 956532W 26X26X11.5Hcm
18 956500W 26X24.5X10Hcm
19 956501W 32.5X25X11.5Hcm





colour options

- 1 960624 24.5x20.5x12Hcm
- 2 960626 3PCS/SET
S:17.5x16.5x10.5Hcm
M:21.5x20.5x12.5Hcm
L:26.5x24.5x14.5Hcm
- 3 960591 3PCS/SET
S:Ø19.5x9.5Hcm
M:Ø23x11Hcm
L:Ø27.5x13Hcm
- 4 960592 3PCS/SET
S:19.5x19.5x10Hcm
M:24x24x12Hcm
L:28.5x28.5x14Hcm
- 5 960610 3PCS/SET
S:Ø15x7.5Hcm
M:Ø17x7.5Hcm
L:Ø18.5x8.5Hcm
- 6 960611 3PCS/SET
S:Ø18x10.5Hcm
M:Ø22x13Hcm
L:Ø26x15Hcm

- 7 960586 2PCS/SET
S:Ø24x13Hcm
L:Ø28x16Hcm
- 8 960585 3PCS/SET
S:Ø17.5x10Hcm
M:Ø21.5x12Hcm
L:Ø25.5x14.5Hcm
- 9 960625 Ø26x14.5Hcm
- 10 960376 31xØ24.5x14.5Hcm
- 11 960367 35xØ15.8x13.5Hcm
- 12 960375 31xØ24.5x14Hcm
- 13 960368S 26.8xØ22x12.5Hcm
960368M 32xØ25.8x14Hcm
960368L 34xØ27.5x16Hcm
- 14 960382 3PCS/SET
S:Ø20.5x9.1Hcm
M:Ø22.2x10.7Hcm
L:Ø24.6x11.4Hcm



colour options





colour options



15



16



17

colour options



28



29

| | | | | | |
|----|---------|-----------------|----|---------|----------------------|
| 15 | 956220 | 41.5X28X17.8HCM | 23 | 960133 | 25.5X24.5X15.5HCM |
| 16 | 956218 | 43X26X15.5HCM | 24 | 960132 | Ø24X20HCM |
| 17 | 956219 | 38X26X20HCM | 25 | 956150 | 26X24X16HCM |
| 18 | 956175A | Ø26X22HCM | 26 | 956151 | 26X25.5X22HCM |
| 19 | 956175B | Ø26X22HCM | 27 | 956242S | 37X26X1.6HCM |
| 20 | 956176 | 25X21.5HCM | | 956242L | 42X32.3X1.68HCM |
| 21 | 956178 | Ø19.5X24.5HCM | 28 | 956261 | 11.4X5.7X3.8HCM |
| 22 | 956177 | Ø24.5X32X22HCM | 29 | 960323 | (47.5-86)X28X33.5HCM |



27



24

23



19

18



21



25

26



22



20



DISH RACK

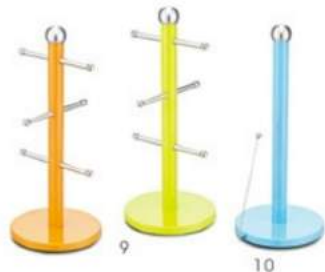

- | | | |
|----|--------|-------------------|
| 1 | 960582 | 49x32x32.5Hcm |
| 2 | 960583 | 48x31.5x22Hcm |
| 3 | 960584 | 51.5x23.5x66Hcm |
| 4 | 960623 | 54x25.5x38.5Hcm |
| 5 | 960621 | 54.5x25.5x38Hcm |
| 6 | 960622 | 52.5x25.5x34.5Hcm |
| 7 | 960137 | Ø15X31Hcm |
| 8 | 960136 | Ø15X30.5Hcm |
| 9 | 960373 | Ø15X35.5Hcm |
| 10 | 960374 | Ø15X35.5Hcm |
| 11 | 960427 | Ø15X35.5Hcm |
| 12 | 960982 | 45.5X33X11.5Hcm |





13



14



15

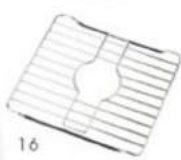

16



17



18



19



20

- | | | |
|----|---------|-----------------|
| 13 | 959960 | 31.5X27X2Hcm |
| 14 | 959965 | 41.5X31X2Hcm |
| 15 | 959966 | 47.3X32X2Hcm |
| 16 | 959957 | 31.5X27X2Hcm |
| 17 | 959958 | 41.5X31X2Hcm |
| 18 | 959967 | 47.3X32X2Hcm |
| 19 | 959956 | 32X26X18Hcm |
| 20 | 959943 | 17X19.5x8Hcm |
| 21 | 960050 | Ø16X32Hcm |
| 22 | 960051 | Ø16X33Hcm |
| 23 | 960048 | Ø15.5x39.5Hcm |
| 24 | 960049 | Ø15.5X36Hcm |
| 25 | 959988 | 41X5.5X14.5Hcm |
| 26 | 958311E | 44.5X35X15Hcm |
| 27 | 960079 | 51.5X32X25.5Hcm |



21



22



23



24



27



26



28

- | | | |
|----|---------|-------------------|
| 28 | 960522 | 42.2X31.5X27.7Hcm |
| 29 | 960439 | 52X35X26Hcm |
| 30 | 960439E | 52X35X26Hcm |
| 31 | 960406 | 43.5X36.3X15Hcm |
| 32 | 960398 | 42.8X32X31.5Hcm |
| 33 | 959386 | 44X32X25Hcm |



31



33



32



29

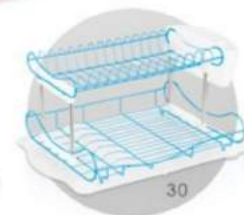

30

MY SIMPLE STORAGE



- 1 959949S 27.5X16X22.5Hcm
959949L 28X28X25Hcm
- 2 959955 44X17.5X15.5Hcm
- 3 959953S 31X25X13Hcm
959953L 44.5X25X13.5Hcm
- 4 959946 25.5X23.5X11Hcm
- 5 959944 28.5x9x11Hcm
- 6 959947 29.5x7x20.5Hcm
- 7 927427E Ø24X18.5H.X30.5H.cm
- 8 927426E 24X24X19H.X31.5H.cm
- 9 959945 30X13X12.5Hcm
- 10 959964 33.5X14.5X11.5Hcm
- 11 959959 28.5X17.5X18.5Hcm
- 12 959950 33.5X25X19Hcm
- 13 959951 30.5X24.5X20Hcm
- 14 959963 23X23X20Hcm



1



2



3



9



10



5



6



7



8



13



11



12



14



38



39

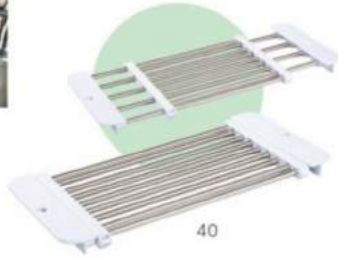

40



20



19



21



18



17



15



35



36

- 15 959972 37X27X60.5Hcm
- 16 960378 Ø30X2Hcm
- 17 959971 36X23.5X63.5Hcm
- 18 959970 38.5X24.5X77.5Hcm
- 19 959969E 36.5X26X65.5Hcm
- 20 959968E 40.5X18X63.5Hcm
- 21 959968 40.5X18X63.5Hcm
- 22 960146 117x19x14.6Hcm
- 23 960053 27X27X11.5Hcm
- 24 960054 35.5X25X15Hcm
- 25 959987 Ø26.5X40.5Hcm
- 26 9599285E 26X26X7.2Hcm
- 959928LE 30X30X7.7Hcm
- 27 959932E 28X28X8Hcm
- 28 9599295E 26X26X7Hcm
- 959929LE 30X30X7.5Hcm

- 29 959933SE 20X20X11Hcm
- 959933LE 26X26X11.5Hcm
- 30 959930SE 20X20X11.2Hcm
- 959930LE 26X26X11.7Hcm
- 31 959986 14.4X5.8X13.4Hcm
- 32 959984 Ø10.5X16Hcm
- 33 959983 Ø14X34.5Hcm
- 34 959985 Ø16X32.5Hcm
- 35 960721 33X28X23Hcm
- 36 960722 37X26.5X26Hcm
- 37 960718 Ø29X11Hcm
- 38 960730 15.5X(30.5-52.5)X9Hcm
- 39 960729 49.5X18.5X1Hcm
- 40 960972 16X(34-58)X2Hcm



23



24



37



25



16



27



28



29



30



26



31



32



33

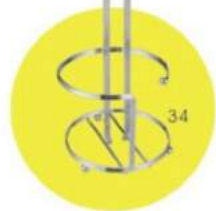

34

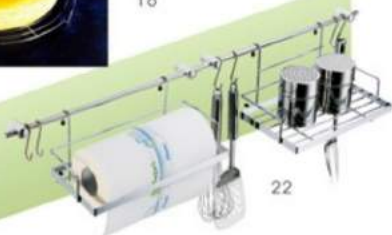

22



NATURAL KITCHEN



- | | | | | | |
|---|--------|----------------|----|---------|-------------------|
| 1 | 907412 | 34.5X24X2Hcm | 9 | 907413 | 35.5X23.7X19.3Hcm |
| 2 | 907408 | 50X21X1.5Hcm | 10 | 907402 | 30.5X6.5X1.5Hcm |
| 3 | 907411 | 23.4X50X1.5Hcm | 11 | 907403 | 30.5X6.5X1.5Hcm |
| 4 | 907404 | 43X30X1.5Hcm | 12 | 907406 | 31X19X2.5Hcm |
| 5 | 907410 | 52X25X2Hcm | 13 | 907414 | 42X17X11Hcm |
| 6 | 907407 | 35.5X25X1Hcm | 14 | 907339 | (23-28)X20X1.8Hcm |
| 7 | 907409 | 31.8X25X1Hcm | 15 | 907337 | 55.5X29X32Hcm |
| 8 | 907405 | 33X23X1Hcm | 16 | 907338 | 40X35X26Hcm |
| | | | 17 | 907343A | 38X12.5X30.5Hcm |

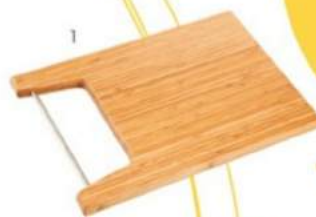



18



19



20



21



23

| | | | |
|----|--------|-----------------|-----------|
| 18 | 960483 | 32.5X23X18Hcm | (72PCS L) |
| 19 | 960484 | 29.5X20.5X14Hcm | (72PCS M) |
| 20 | 960480 | 32.5X18X12.5Hcm | (36PCS L) |
| 21 | 960520 | 27.5X18X12.5Hcm | (30PCS L) |
| 22 | 960452 | 29.5X16X10Hcm | (36PCS M) |
| 23 | 960478 | 39.5X25X5.5Hcm | (60PCS S) |
| 24 | 960481 | 33X32.5X7Hcm | (36PCS L) |
| 25 | 960482 | 39.5X21.5X6Hcm | (50PCS S) |
| 26 | 960479 | 29.5X25.5X6Hcm | (30PCS M) |



22



24



25



26



my NEW

KITCHEN



- | | | |
|----|--------|------------------|
| 1 | 956376 | 32.5X9X10Hcm |
| 2 | 956375 | 32.5X7.5X5.5Hcm |
| 3 | 956374 | 32.5X7.7X5.3Hcm |
| 4 | 956373 | 33X7.5X5Hcm |
| 5 | 956372 | 31X10.6X7.3Hcm |
| 6 | 956371 | 32.5X10.5X7.8Hcm |
| 7 | 956370 | 33X12.7X5.8Hcm |
| 8 | 956369 | 33X8X7.2Hcm |
| 9 | 956347 | 33.5X6.7X6.5Hcm |
| 10 | 956349 | 31X8.5X7.5Hcm |
| 11 | 956345 | 31X7.5X6.5Hcm |
| 12 | 956346 | 33X6.6X6.7Hcm |
| 13 | 956348 | 32.5X8.3X7.5Hcm |



colour options



| | | | | | |
|----|--------|---------------|----|--------|-----------------|
| 14 | 956368 | 17.6X8X4Hcm | 27 | 956411 | 21X3.8X4Hcm |
| 15 | 956366 | 14.1X5.5X4Hcm | 28 | 956355 | 18.5X7.5X1.5Hcm |
| 16 | 956367 | 9.1X5.9X4Hcm | 29 | 956352 | 15X6X3Hcm |
| 17 | 956363 | 18.8X8X4Hcm | 30 | 956359 | 16.5X6.5X1.3Hcm |
| 18 | 956364 | 15X7X4Hcm | 31 | 956354 | 19X4.5X3Hcm |
| 19 | 956362 | 16.1X4.7X4Hcm | 32 | 956357 | 17.5X2.3X2Hcm |
| 20 | 956399 | Ø3.8X19.8Hcm | 33 | 956356 | 18.5X4.4X3Hcm |
| 21 | 956406 | 18.5X8X4Hcm | 34 | 956360 | 14.1X4.5X1.5Hcm |
| 22 | 956412 | 15.5X5.5X4Hcm | 35 | 956358 | 16.1X4.3X2.4Hcm |
| 23 | 956410 | 20X6X4Hcm | 36 | 956361 | 17X8.5X4.3Hcm |
| 24 | 956409 | 20X8X3.8Hcm | 37 | 956351 | 26X6.5X3.5Hcm |
| 25 | 956407 | 16X7X4Hcm | 38 | 956353 | 30X5X1Hcm |
| 26 | 956408 | 17X4.5X4Hcm | | | |



KITCHEN TOOLS

- 1 960944 20X4X1.5Hcm
- 2 960945 25X5.5X1.5Hcm
- 3 960943 18X5.5X2Hcm
- 4 960946 21X7.5X1.5Hcm
- 5 960942 21X5X4Hcm
- 6 960941 6PCS/SET
- 7 960950 33.5X7.5X2.5Hcm
- 8 960953 31X6X3.5Hcm
- 9 960951 31X6.5X5Hcm
- 10 960948 31X6.5X5Hcm
- 11 960947 30X9X6Hcm
- 12 960954 31.5X11.5X6Hcm
- 13 960952 33.5X7.5X2.5Hcm
- 14 956614 29X9.5X7Hcm
- 15 956617 29X7X7Hcm
- 16 956616 31X6.5X5Hcm
- 17 956612 31X6.5X3.5Hcm
- 18 956613 31.5X9X6Hcm
- 19 956615 31.5X9X6.5Hcm
- 20 956611 7PCS/SET



1 2 3 4 5



14 15 16 17 18 19



6



7 8 9 10 11 12 13



20

- 21 956629 29X6.5X7.5Hcm
- 22 956627 31.5X7X7Hcm
- 23 956628 31.5X7X6Hcm
- 24 956625 31X5X6.5Hcm
- 25 956626 31X8.5X6Hcm
- 26 956630 29X9X9Hcm
- 27 956624 30.5X7X7Hcm
- 28 956619 33X5.5X6Hcm
- 29 956618 32.5X7X5.5Hcm
- 30 956621 32.5X9.5X7Hcm





21 22 23 24 25 26



41 42 43 44 45



46 47



27 28 29 30 31 32 33

- 48 956580 26.5X9X9Hcm
- 49 956584 30X8X7Hcm
- 50 956585 28.5X6X4.5Hcm
- 51 956583 27.5X9X10.5Hcm
- 52 956582 28X9X7Hcm
- 53 956581 26X4.5X4.5Hcm
- 54 956579 30X8X7.5Hcm
- 55 956600 27.5X6X2Hcm

- 31 956623 34X9.5X3.5Hcm
- 32 956622 35X10.5X4.5Hcm
- 33 956620 33X7X5Hcm
- 34 960938 26.5X8X7Hcm
- 35 960936 33X8X2.5Hcm
- 36 960937 30X9X6Hcm
- 37 960935 32.5X11.5X5.5Hcm
- 38 960940 31X7X4Hcm
- 39 960939 31X7X4Hcm
- 40 960934 7PCS/SET
- 41 956575 27X6X1.5Hcm
- 42 956599 27.5X6X2Hcm
- 43 956573 30X8X7.5Hcm
- 44 956576 28X6X2Hcm
- 45 956577 28X9X7Hcm
- 46 956574 Ø9X26Hcm
- 47 956578 26X4.5X4Hcm



40



34 35 36 37 38 39



- | | | | |
|----------|-----------|-----------------|-------|
| 1 | 903979PA | Ø17X24.5Hcm | (3L) |
| | 903979PB | Ø20.5X27Hcm | (5L) |
| | 903979PC | Ø25X39Hcm | (12L) |
| 2 | 903979PSA | Ø17X24.5Hcm | (3L) |
| | 903979PSB | Ø20.5X27Hcm | (5L) |
| | 903979PSC | Ø25X39Hcm | (12L) |
| 3 | 927984PA | Ø17X27Hcm | (3L) |
| | 927984PB | Ø20.5X30Hcm | (5L) |
| | 927984PC | Ø25X41Hcm | (12L) |
| 4 | 960783 | 40.5X26.5X24Hcm | |
| 5 | 960786 | 16X8.5X16Hcm | |
| 6 | 960785 | 20X20X2.5Hcm | |
| 7 | 960787 | 16X8X13Hcm | |
| 8 | 960784 | 24X19X4.5Hcm | |

KITCHEN



4



5



7



6



8



- | | | | | | |
|-----------|--------|----------------------|-----------|--------|-----------------|
| 9 | 960636 | Ø8.5X13H.X37.5H.cm | 14 | 960781 | 27.5X20.5X58Hcm |
| 10 | 960642 | Ø9.5X13.4H.X35.5H.cm | 15 | 960780 | 34.5X25.5X58Hcm |
| 11 | 960641 | 4PCS/SET | 16 | 960778 | 30X17X58Hcm |
| 12 | 960635 | 4PCS/SET | 17 | 960782 | 25X12X58Hcm |
| 13 | 960779 | 34.5X25.5X58Hcm | 18 | 960810 | 26X12X58Hcm |



13



14



15



16



17



18



- | | | | |
|----|----------|---|---------|
| 1 | 960413 | Ø33.8X13Hcm | |
| 2 | 959465 | Ø13.5X14Hcm | |
| 3 | 960319SE | 15.5X21X11.5Hcm | (1.0L) |
| | 960319ME | 18.5X24X13Hcm | (1.5L) |
| | 960319LE | 18.5X24.5X15Hcm | (2.0L) |
| 4 | 960320SE | 15.5X21X15Hcm | (1.0L) |
| | 960320ME | 18.5X24X16Hcm | (1.5L) |
| | 960320LE | 18.5X24.5X18.2Hcm | (2.0L) |
| 5 | 960320S | 15.5X21X15Hcm | (1.0L) |
| | 960320M | 18.5X24X16Hcm | (1.5L) |
| | 960320L | 18.5X24.5X18.2Hcm | (2.0L) |
| 6 | 960319S | 15.5X21X11.5Hcm | (1.0L) |
| | 960319M | 18.5X24X13Hcm | (1.5L) |
| | 960319L | 18.5X24.5X15Hcm | (2.0L) |
| 7 | 960321S | 9X14.5X17.5Hcm | (400ml) |
| | 960321L | 11.5X16.5X20.2Hcm | (800ml) |
| 8 | 960009 | 22.5XØ18X20Hcm | |
| 9 | 960010 | 29.5XØ23X25Hcm | |
| 10 | 959699L | Ø8.9X33.5Hcm | (1.7L) |
| 11 | 959699M | Ø8.9X29.5Hcm | (1.4L) |
| 12 | 959699S | Ø8.9X24Hcm | (1.2L) |
| 13 | 958150 | Ø25XØ21X28Hcm | |
| 14 | 958149 | Ø30X7Hcm | |
| 15 | 958148 | Ø26.5X2Hcm | |
| 16 | 958151 | 42.5X27.5X6.5Hcm | |
| 17 | 958152 | 2PCS/SET S:30.5X24X5.5Hcm L:37X28X6Hcm | |
| 18 | 960405 | 22X22X20Hcm | |





19



21



20



22

23

24

| | | |
|----|--------|-------------------|
| 19 | 960388 | 31X5.2X2.4Hcm |
| 20 | 960402 | 30.7X5.3X2.2Hcm |
| 21 | 960389 | 38.6X3.5X2.2Hcm |
| 22 | 960391 | 7.2X8.2X16Hcm |
| 23 | 960393 | 10.2X8.9X20.6Hcm |
| 24 | 960392 | 9.7X10.2X23.5Hcm |
| 25 | 960390 | 10.6X8X23.9Hcm |
| 26 | 960396 | 11.6X5.6X23.7Hcm |
| 27 | 960397 | 10.6X8.1X22.5Hcm |
| 28 | 960395 | 13.2X11.5X23Hcm |
| 29 | 960394 | 10.7X13.6X23.5Hcm |



25



26



27



28



29



ART. NO. 960575

Description: Main Material: stainless steel 201 #
.Handle: nylon fixed handle
.Body Thickness: 0.3mm
.Bottom: stainless steel 201 # single bottom
.Finish: outside mirror polish
.Lid: nylon

Capacity: 2.5L
Package: Inner packing: 1 PC/color box
.Case pack: 12 PCS
.Carton size: 63X42X47.5CM
.MOQ 1X20' GP: 2700PCS



ART. NO. 960469

Description: Main Material: stainless steel 201 #
.Handle: nylon fixed handle
.Body Thickness: 0.3mm
.Bottom: stainless steel 201 # single bottom
.Finish: outside mirror polish
.Lid: nylon

Capacity: 2.5L
Package: Inner packing: 1PC/colour box
.Case pack: 12 pcs
.Carton size: 63X42X47.5CN
.MOQ 1X20' GP: 2700PCS



ART. NO. 960467

Description: Main Material: stainless steel 201 #
.Handle: nylon moving handl
.Body Thickness: 0.3mm
.Bottom: stainless steel 201 # single bottom
.Finish: outside mirror polish
.Lid: stainless steel 201 # & nylon

Capacity: 2.5L
Package: Inner packing: 1PC/colour box
.Case pack: 12 pcs
.Carton size: 58.5X39X31.5CM
.MOQ 1X20' GP: 4680PCS



ART. NO. 960468

Description: Main Material: stainless steel 201 #
.Handle: nylon moving handle
.Body Thickness: 0.3mm
.Bottom: stainless steel 201 # single bottom
.Finish: outside mirror polish
.Lid: stainless steel 201 # & nylon

Capacity: 1.8L
Package: Inner packing: 1PC/colour box
.Case pack: 12 pcs
.Carton size: 58.5X39X33.8CM
.MOQ 1X20' GP: 4440PCS



ART. NO. 960473E

Description: Main Material: stainless steel 201 #
.Handle: nylon moving handle
.Body Thickness: 0.3mm
.Bottom: stainless steel 201 # single bottom
.Finish: outside mirror polish
.Lid: stainless steel 201 # & nylon

Capacity: 1.5L
Package: Inner packing: 1PC/colour box
.Case pack: 12 pcs
.Carton size: 54X36X28.5CM
.MOQ 1X20' GP: 6240PCS



ART. NO. 960470

Description: Main Material: stainless steel 201 #
.Handle: nylon moving handle
.Body Thickness: 0.3mm
.Bottom: stainless steel 201 # single bottom
.Finish: outside mirror polish
.Lid: stainless steel 201 # & nylon

Capacity: 2.5L
Package: Inner packing: 1PC/colour box
.Case pack: 12 pcs
.Carton size: 58.5X39X31.5CM
.MOQ 1X20' GP: 4680PCS



ART. NO. 960473

Description: Main Material: stainless steel 201 #
.Handle: nylon moving handle
.Body Thickness: 0.3mm
.Bottom: stainless steel 201 # single bottom
.Finish: outside mirror polish
.Lid: stainless steel 201 # & nylon

Capacity: 1.5L
Package: Inner packing: 1PC/colour box
.Case pack: 12 pcs
.Carton size: 54X36X28.5CM
.MOQ 1X20GP: 6240PCS



ART. NO. 960475

Description: Main Material: stainless steel 201 #
.Handle: nylon moving handle
.Body Thickness: 0.3mm
.Bottom: stainless steel 201 # single bottom
.Finish: outside mirror polish
.Lid: stainless steel 201 # & nylon

Capacity: 1.8L
Package: Inner packing: 1PC/colour box
.Case pack: 12 pcs
.Carton size: 58.5X39X33CM
.MOQ 1X20' GP: 4440PCS



ART. NO. 960476

Description: Main Material: stainless steel 201 #
.Handle: nylon fixed handle
.Body Thickness: 0.3mm
.Bottom: stainless steel 201 # single bottom
.Finish: outside mirror polish
.Lid: nylon

Capacity: 2.5L
Package: Inner packing: 1PC/colour box
.Case pack: 12 pcs
.Carton size: 63X42X47.5CM
.MOQ 1X20' GP: 2700PCS



ART. NO. 960471

Description: Main Material: stainless steel 201 #
.Handle: nylon fixed handle
.Body Thickness: 0.3mm
.Bottom: stainless steel 201 # single bottom
.Finish: outside mirror polish
.Lid: nylon

Capacity: 2.5L
Package: Inner packing: 1 PC/color box
.Case pack: 12 PCS
.Carton size: 63X42X47.5CM
.MOQ 1X20' GP: 2700PCS



ART. NO. 960474

Description: Main Material: stainless steel 201 #
.Handle: nylon fixed handle
.Body Thickness: 0.3mm
.Bottom: stainless steel 201 # single bottom
.Finish: outside mirror polish
.Lid: nylon

Capacity: 2.5L
Package: Inner packing: 1PC/colour box
.Case pack: 12 pcs
.Carton size: 63X42X47.5CM
.MOQ 1X20' GP: 2700PCS



ART. NO. 960472

Description: Main Material: stainless steel 201 #
.Handle: nylon fixed handle
.Body Thickness: 0.3mm
.Bottom: stainless steel 201 # single bottom
.Finish: outside mirror polish
.Lid: nylon

Capacity: 2.5L
Package: Inner packing: 1PC/colour box
.Case pack: 12 pcs
.Carton size: 63X42X47.5CM
.MOQ 1X20GP: 2700PCS



iKETTLE

ART.NO. 960317

Description: Main Material: stainless steel 201 #
 .Handle: stainless steel & silicon combined
 .Body Thickness: 0.5MM
 .Bottom: encapsulated bottom with 0.5mm ss
 18/0 + 1.0mm aluminium + 1.0mm iron
 .Lid: Stainless steel

Capacity: 3.0L
 Package: Inner packing: 1PC/colour box
 .Case pack: 12pcs
 .carton size: 69X46X38 CM
 MOQ 1X20GP: 2784 PCS



ART.NO. 960313

Description: Main Material: stainless steel 201 #
 .Handle: nylon fixed handle
 .Body Thickness: 0.6MM
 .Bottom: stainless steel 18/0 single bottom
 .Lid: nylon

Capacity: 3.0L
 Package: Inner packing: 1PC/colour box
 .Case pack: 12pcs
 .carton size: 67.5X45.5X43 CM
 .MOQ 1X 20GP: 2544PCS



ART.NO. 960314

Description: Main Material: stainless steel 201 #
 .Handle: nylon fixed handle
 .Body Thickness: 0.4MM
 .Bottom: stainless steel 18/0 single bottom
 .Lid: nylon

Capacity: 2.5L
 Package: Inner packing: 1PC/colour box
 .Case pack: 12pcs
 .carton size: 60X40.5X50 CM
 .MOQ 1X20GP: 2760 PCS



ART.NO. 960315

Description: Main Material: stainless steel 201 #
 .Handle: nylon fixed handle
 .Body Thickness: 0.4MM
 .Bottom: stainless steel 18/0 single bottom
 .Lid: nylon

Capacity: 2.5L
 Package: Inner packing: 1PC/colour box
 .Case pack: 12pcs
 .carton size: 60X40.5X49 CM
 .MOQ 1X20GP: 2820 PCS



ART.NO. 960312

Description: Main Material: stainless steel 201 #
 .Handle: nylon fixed handle
 .Body Thickness: 0.4MM
 .Bottom: stainless steel 18/0 single bottom
 .Lid: nylon

Capacity: 3.0L
 Package: Inner packing: 1PC/colour box
 .Case pack: 12pcs
 .carton size: 63X42.5X45CM
 .MOQ 1X20GP: 2784 PCS



ART.NO. 960318

Description: Main Material: stainless steel 201 #
 .Handle: nylon fixed handle
 .Body Thickness: 0.5MM
 .Bottom: encapsulated bottom with 0.5mm ss
 18/0 + 1.0mm aluminium + 1.0mm iron
 .Lid: Stainless steel

Capacity: 3.0L
 Package: Inner packing: 1PC/colour box
 .Case pack: 12pcs
 .carton size: 69X46X43 CM
 .MOQ 1X20GP: 2460 PCS



ART.NO. 960316

Description: Main Material: stainless steel 201 #
 .Handle: stainless steel & silicon combined
 .Body Thickness: 0.5MM
 .Bottom: encapsulated bottom with 0.5mm ss
 18/0 + 1.0mm aluminium + 1.0mm iron
 .Lid: nylon

Capacity: 3.0L
 Package: Inner packing: 1PC/colour box
 .Case pack: 12pcs
 .carton size: 69X46X50 CM
 .MOQ 1X20GP: 2112 PCS



i KETTLE



ART.NO. 959701

Description: Main Material: stainless steel 201#
 .Handle: nylon fixed handle
 .Body Thickness: 0.35mm
 .Bottom: stainless steel 201# single bottom
 .Finish: outside mirror polish
 .Lid: nylon
 Capacity: 3.0L
 Package: Inner packing: 1 PC/color box
 .Case pack: 12 PCS
 .Carton size: 63X42.5X48CM
 .MOQ 1X20GP: 2748PCS

ART.NO. 959702

Description: Main Material: stainless steel 201#
 .Handle: nylon fixed handle
 .Body Thickness: 0.6mm
 .Bottom: stainless steel 201# single bottom
 .Finish: outside mirror polish
 .Lid: nylon
 Capacity: 3.0L
 Package: Inner packing: 1 PC/color box
 .Case pack: 12 PCS
 .Carton size: 68X45.5X44CM
 .MOQ 1X20GP: 2616PCS



ART.NO. 961008

Description: Main Material: stainless steel 201#
 .Handle: nylon fixed handle
 .Body Thickness: 0.35mm
 .Bottom: stainless steel 430# single bottom
 .Finish: outside mirror polish
 .Lid: nylon
 Capacity: 3.0L
 Package: Inner packing: 1PC/color box
 .Case pack: 12 PCS
 .Carton size: 67.5X45.5X49CM
 .MOQ 1X20GP: 2268PCS



ART.NO. 961009

Description: Main Material: stainless steel 201#
 .Handle: zinc alloy & nylon fixed handle
 .Body Thickness: 0.35mm
 .Bottom: stainless steel 430# single bottom
 .Finish: outside mirror polish
 .Lid: nylon
 Capacity: 3.0L
 Package: Inner packing: 1PC/color box
 .Case pack: 12 PCS
 .Carton size: 67.5X45.5X48CM
 .MOQ 1X20GP: 2316PCS



ART.NO. 961000

Description: Main Material: stainless steel 201#
 .Handle: nylon fixed handle
 .Body Thickness: 0.6mm
 .Bottom: encapsulated bottom with 0.5mm
 430ss + 1.0mm aluminium + 2.5mm iron
 .Finish: outside mirror polish
 .Lid: nylon
 Capacity: 2.5L
 Package: Inner packing: 1PC/color box
 .Case pack: 12 PCS
 .Carton size: 58.5X39.5X50CM
 .MOQ 1X20GP: 2952PCS



ART.NO. 961010

Description: Main Material: stainless steel 201#
 .Handle: nylon fixed handle
 .Body Thickness: 0.6mm
 .Bottom: encapsulated bottom with 0.5mm
 430ss + 1.0mm aluminium + 2.5mm iron
 .Finish: outside mirror polish
 .Lid: nylon
 Capacity: 2.5L
 Package: Inner packing: 1PC/color box
 .Case pack: 12 PCS
 .Carton size: 58.5X39.5X51CM
 .MOQ 1X20GP: 2868PCS



ART.NO. 961003

Description: Main Material: stainless steel 201 #
Handle: zinc alloy & nylon fixed handle
Body Thickness: 0.3mm
Bottom: stainless steel 430# single bottom
Finish: outside satin polish
Lid: nylon

Capacity: 3.0L

Package: Inner packing: 1PC/color box
.Case pack: 12 PCS
.Carton size: 62X41.5X47CM
MOQ 1X20'GP: 2820PCS



ART.NO. 961004

Description: Main Material: stainless steel 201 #
Handle: nylon fixed handle
Body Thickness: 0.5mm
Bottom: stainless steel 201 # single bottom
Finish: outside mirror polish
Lid: nylon

Capacity: 3.0L

Package: Inner packing: 1PC/color box
.Case pack: 12 PCS
.Carton size: 67.5X45.5X44CM
MOQ 1X20'GP: 2616PCS



ART.NO. 961001

Description: Main Material: stainless steel 201 #
Handle: nylon fixed handle
Body Thickness: 0.5mm
Bottom: stainless steel 201 # single bottom
Finish: outside mirror polish
Lid: nylon

Capacity: 3.0L

Package: Inner packing: 1PC/color box
.Case pack: 12 PCS
.Carton size: 67.5X45.5X44CM
MOQ 1X20'GP: 2616PCS



ART.NO. 961006

Description: Main Material: stainless steel 201 #
Handle: nylon fixed handle
Body Thickness: 0.3mm
Bottom: stainless steel 430# single bottom
Finish: outside mirror polish
Lid: nylon

Capacity: 2.5L

Package: Inner packing: 1PC/color box
.Case pack: 12 PCS
.Carton size: 58.5X39.5X46CM
MOQ 1X20'GP: 3216PCS



ART.NO. 961002

Description: Main Material: stainless steel 201 #
Handle: nylon fixed handle
Body Thickness: 0.3mm
Bottom: stainless steel 430# single bottom
Finish: outside mirror polish
Lid: stainless steel 201 #

Capacity: 2.0L

Package: Inner packing: 1PC/color box
.Case pack: 12 PCS
.Carton size: 55.5X37.5X40CM
MOQ 1X20'GP: 4248PCS



ART.NO. 961005

Description: Main Material: stainless steel 201 #
Handle: nylon fixed handle
Body Thickness: 0.5mm
Bottom: stainless steel 201 # single bottom
Finish: outside mirror polish
Lid: nylon

Capacity: 3.0L

Package: Inner packing: 1PC/color box
.Case pack: 12 PCS
.Carton size: 67.5X45.5X43CM
MOQ 1X20'GP: 2616PCS



ART.NO. 961007

Description: Main Material: stainless steel 201 #
Handle: nylon fixed handle
Body Thickness: 0.5mm
Bottom: stainless steel 201 # single bottom
Finish: outside mirror polish
Lid: nylon

Capacity: 2.5L

Package: Inner packing: 1PC/color box
.Case pack: 12 PCS
.Carton size: 62X41.5X46CM
MOQ 1X20'GP: 2880PCS



ART.NO.959716

Description: Main Material: stainless steel 201 #
 .Handle: nylon fixed handle
 .Body Thickness: 0.4mm
 .Bottom: stainless steel 18/0 single bottom
 .Color: yellow
 .Lid: nylon

Capacity: 2.5L
 Package: Inner packing: 1 PC/color box
 .Case pack: 12 PCS
 .Carton size: 62X41.5X51CM
 .MOQ 1X20GP: 2448PCS



ART.NO. 959707

Description: Main Material: stainless steel 201 #
 .Handle: nylon fixed handle
 .Body Thickness: 0.4mm
 .Bottom: stainless steel 18/0 single bottom
 .Finish: outside with paint
 .Lid: Stainless steel 201

Capacity: 2.0L
 Package: Inner packing: 1 PC/color box
 .Case pack: 12 PCS
 .Carton size: 58X39X37CM
 .MOQ 1X20GP: 3840PCS



ART.NO.959706

Description: Main Material: stainless steel 201 #
 .Handle: nylon fixed handle
 .Body Thickness: 0.7mm
 .Bottom: stainless steel 201 # single bottom
 .Finish: outside with paint
 .Lid: nylon

Capacity: 3.0L
 Package: Inner packing: 1 PC/color box
 .Case pack: 12 PCS
 .Carton size: 69.5X47X44CM
 .MOQ 1X20GP: 2244PCS



ART.NO. 959708

Description: Main Material: stainless steel 201 #
 .Handle: nylon fixed handle
 .Body Thickness: 0.4mm
 .Bottom: encapsulated bottom with stainless steel 18/0 + 1.0mm aluminium
 .Color: Green
 .Lid: Stainless steel 201

Capacity: 3.0L
 Package: Inner packing: 1 PC/color box
 .Case pack: 8 PCS
 .Carton size: 47X46.5X51CM
 .MOQ 1X20GP: 1928PCS



ART.NO. 959709

Description: Main Material: stainless steel 201 #
 .Handle: stainless steel
 .Body Thickness: 0.5mm
 .Bottom: encapsulated bottom with 0.4mm SS 18/0 + 1.0mm aluminium + 1.0 iron
 .Finish: outside with paint
 .Lid: Stainless steel 201

Capacity: 3.0L
 Package: Inner packing: 1 PC/color box
 .Case pack: 8 PCS
 .Carton size: 47X46.5X51CM
 .MOQ 1X20GP: 1928PCS



ART.NO. 959710

Description: Main Material: stainless steel 201 #
 .Handle: stainless steel & silicon combined
 .Body Thickness: 0.5mm
 .Bottom: encapsulated bottom with 0.4mm SS 18/0 + 1.0mm aluminium
 .Finish: outside 1/3 mirror polish + 2/3 with paint
 .Lid: Stainless steel 201

Capacity: 2.5L
 Package: Inner packing: 1 PC/color box
 .Case pack: 12 PCS
 .Carton size: 66X44X46CM
 .MOQ 1X20GP: 2508PCS



ART.NO. 959711

Description: Main Material: stainless steel 201 #
 .Handle: stainless steel
 .Body Thickness: 0.5mm
 .Bottom: encapsulated bottom with 0.4mm SS 18/0 + 1.0mm aluminium + 1.0 iron
 .Finish: outside with paint
 .Lid: Stainless steel 201

Capacity: 3.0L
 Package: Inner packing: 1 PC/color box
 .Case pack: 8 PCS
 .Carton size: 47X46.5X51CM
 .MOQ 1X20GP: 1928PCS



ART.NO. 959712

Description: Main Material: stainless steel 201 #
 .Handle: stainless steel
 .Body Thickness: 0.5mm
 .Bottom: encapsulated bottom with 0.4mm SS 18/0 + 1.0mm aluminium + 1.0 iron
 .Finish: outside with paint
 .Lid: Stainless steel 201

Capacity: 3.0L
 Package: Inner packing: 1 PC/color box
 .Case pack: 8 PCS
 .Carton size: 47X46.5X51CM
 .MOQ 1X20GP: 1928PCS



ART.NO. 959713

Description: Main Material: stainless steel 201 #
 .Handle: nylon fixed handle
 .Body Thickness: 0.4mm
 .Bottom: encapsulated bottom with stainless steel 18/0 + 1.0mm aluminium
 .Color: Yellow
 .Lid: nylon

Capacity: 2.5L
 Package: Inner packing: 1 PC/color box
 .Case pack: 12 PCS
 .Carton size: 62X41.5X51CM
 .MOQ 1X20GP: 2448PCS



ART.NO. 959714

Description: Main Material: stainless steel 201 #
 .Handle: nylon fixed handle
 .Body Thickness: 0.4mm
 .Bottom: stainless steel 18/0 single bottom
 .Finish: outside with paint
 .Lid: nylon

Capacity: 1.8L
 Package: Inner packing: 1 PC/color box
 .Case pack: 12 PCS
 .Carton size: 60.5X40.5X38CM
 .MOQ 1X20GP: 3456PCS



ART.NO.959715

Description: Main Material: stainless steel 201 #
 .Handle: nylon fixed handle
 .Body Thickness: 0.35mm
 .Bottom: stainless steel 201 # single bottom
 .Color: Red
 .Lid: stainless steel

Capacity: 3.0L
 Package: Inner packing: 1 PC/color box
 .Case pack: 12 PCS
 .Carton size: 63X42.5X47CM
 .MOQ 1X20GP: 2808 PCS





ALUMINUM DISH RACK



- | | | |
|---|--------|-----------------|
| 1 | 961022 | 33X24.5X35Hcm |
| 2 | 961021 | 35X15X35Hcm |
| 3 | 961017 | 50X38X22Hcm |
| 4 | 961018 | 42X17.5X11.5Hcm |
| 5 | 961016 | 41X28X13Hcm |
| 6 | 961015 | 30X48.5X11.5Hcm |
| 7 | 961020 | 40X14.5X8.5Hcm |
| 8 | 961019 | 55X38X14Hcm |



good quantity
good price

MOQ
5000



947605(30L)



947604(45L)



957403(48L)



957693(48L)

937105B(5L)



903979A(3L)
903979B(5L)
903979C(12L)



957252A(3L)
957252B(5L)
957252C(12L)



956227



956328



957843S(26L)

MOQ
5000



957755

957753



960025



960265

903756

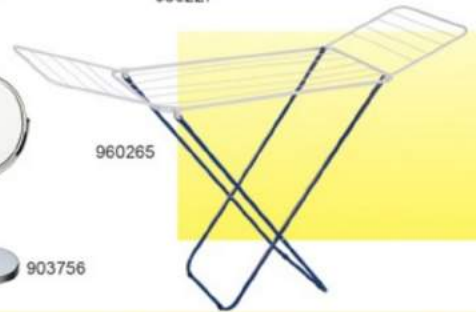

959386



959396

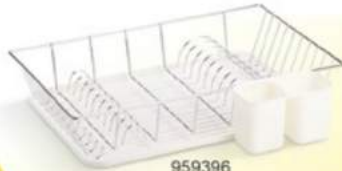

903348S



956252



956336



959624

958231S
958231L



best
buy

MOQ
5000



956325



947681



960341S

ihouse[®]
SINCE 1998



959250A



917204



959993



959992



960740

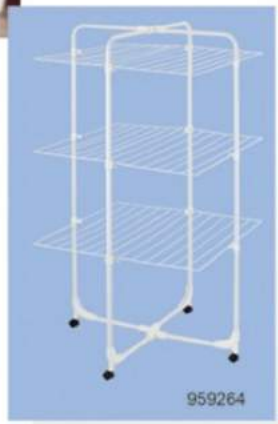

959264



927101E



959729



956221



917649R



903240



917202



903778



947418



960052

957245R



905475



957247R



great buy





 **江門外貿集團有限公司**
JIANGMEN FOREIGN TRADE GROUP CO.,LTD.
I HOUSE ENTERPRISE CO.,LTD

地址：廣東省江門市建設路82號之一外貿大廈
 電話：(750) 3288980 (30線)
 傳真：(750) 3288998 3317703
 郵編：529000
 電子郵件：jftg@gdjftg.com
 網址：Http://www.gdjftg.com

所有抄襲、模仿我司產品的行為均視為非法。我司將採取最嚴厲的法律行動，堅決打擊任何侵權盜版行爲。

Address: Foreign Trade Building, 82-1 Jianshe Road,
 Jiangmen, Guangdong, China
Tel: (750) 3288980 (30 Lines)
Fax: (750) 3288998 3317703
Postcode: 520000
E-mail: jftg@gdjftg.com
Http://www.gdjftg.com

Any copy or imitation of our company's products are considered illegal. Our company will take the most severe legal measures to combat any infringement or piracy.

**C
R
E
A
T
E
F
O
R
U**

